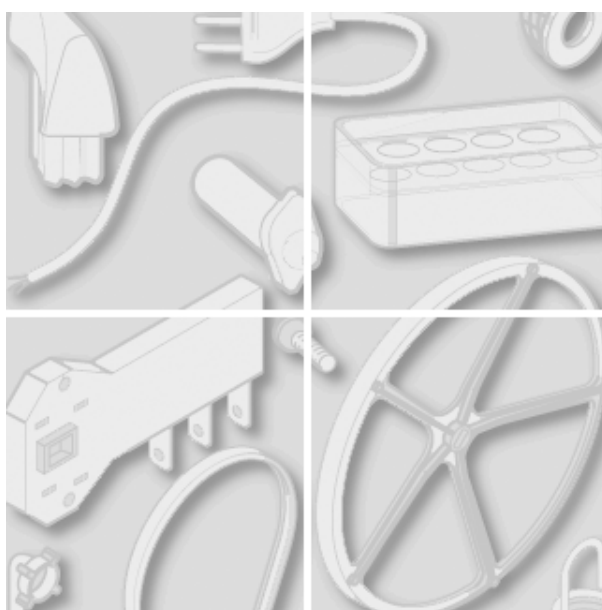


**Indesit** Company



Modell típus:  
**WT100CSI**

termékkód:  
**26899**

## Általános jegyzet

### Technikai Dokumentáció irányelvei

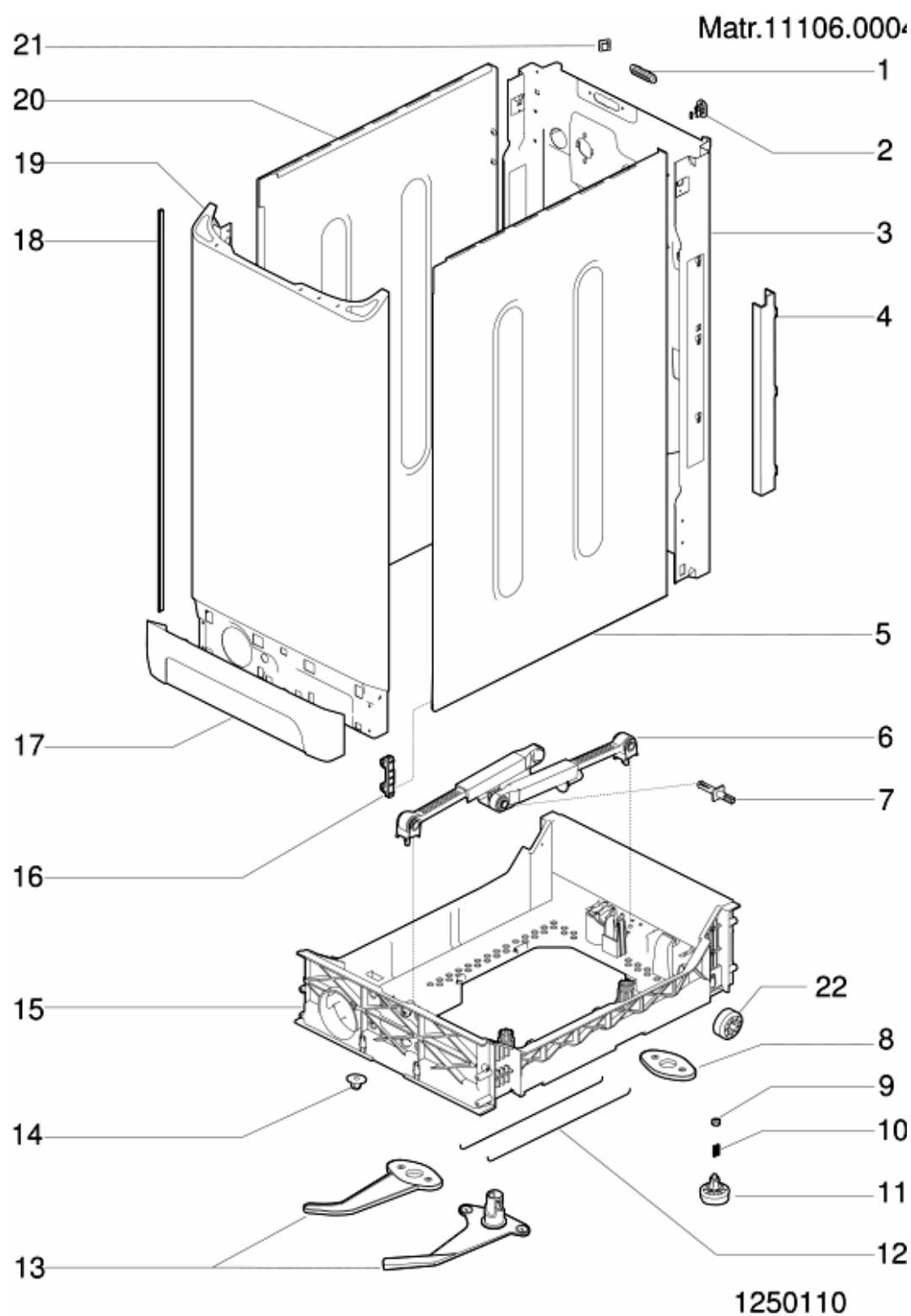
---

Itt néhány általános információ találhatsz a technikai dokumentáció egyszerűbb használatához.

1. Azonos termékcsalád típusai azonos robbantott ábrát tartalmaznak, mely a teljes alkatrész választékot mutatja, általánosságban, nem szükséges, hogy az adott terméknek is alkatrésze az ábrán feltüntetett.
  2. Némely alkatrész bemutatása nem lehetséges közvetlenül a robbantott ábrákon (használati útmutatók, speciális szerelő csomagok, stb...) Ezen kódok megtalálhatók az alkatrészlistán azonos hivatkozási számmal azoknál ahol az alkatrészek be vannak építve vagy 099,999 hivatkozással. A kezelési utasítás, ha már létezik, a 000 referencia számmal lesz ellátva.
  3. Minden robbantott ábra jobb felső sarkában megtalálható a gyári szám, ami mutatja bizonyos modellek gyártásának kezdetét, néhány modellnek létezhet több robbantott ábrája az adott kategóriában, ami a gyári számok alapján különbözik egymástól és egy másik alkatrészlista tartozik hozzá. Ebben az esetben a gyári szám megadása szükséges a helyes alkatrész biztosításához. A robbantott ábra megfelel a legújabb gyári számnak, de az ez előttiékhöz szükséges a megfelelő kiegészítés.
  4. A robbantott ábrák további frissítéseket igényelnek akár már közvetlenül a megjelenés után. Új alkatrészek hozzáadása a jelenlegi referenciaszámok folytatásával történik. A robbantott ábra felülvizsgálati száma a gyári szám utolsó négy digitjében látszódik, a jobb felső sarokban.
  5. A robbantott ábrához tartozó alkatrész lista mutatja a vonatkozó kódokat több modellre is, minden egyes alkatrészhez más információ is rendelkezésre áll
- REF:
- INDUSTRIAL KÓD: a termék különböző változatainak listája (jelezve a termék címkéjén) ahol ez az alkatrész használatos; MEGJEGYZÉS: az információ(k) kódszáma, ami jelöli a teljes szakmai beavatkozást, figyeli a változásokat vagy segít megtalálni a helyes alkatrész kódot.
6. Néhány megjegyzés ugyanabban a részben általános ezért nem csatolódik közvetlenül az alkatrészhez. Azért, hogy a legjobban követhessük a termék változásait, a legjobb, ha követjük az összes megjegyzést és folyamatosan ellenőrizzük a dokumentáció frissítését.
  7. A technikai dokumentáció borítója megmutatja a model nevét és termékkódját

1250110

## Robbantott ábrák



1250110

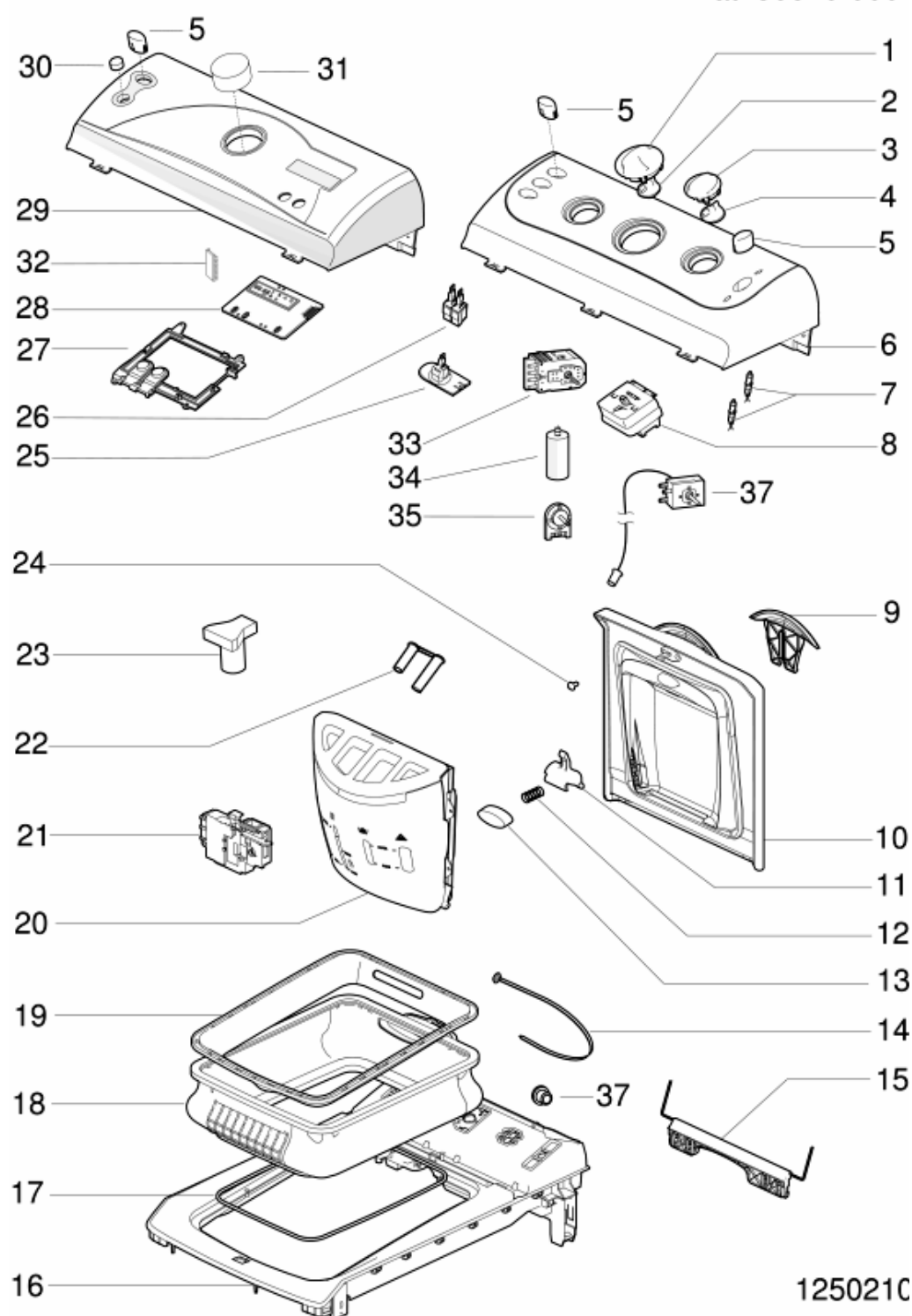
alkatrész lista

refer	Kód	Az S/N	To S/N	Helyettesít	Leírás	jegyzet	ipari kód
000	C00086332				user instructions booklet rus-cs-		
001	C00083909				beüzemelés dugó hardware tl		
002	C00064205				cord lead		
003	C00083784				hátsó panel top ph2001	n1040278	
003	C00091893				hátsó panel top ph2002	n1040288	
003	C00094067			2 x C00097841 1 x C00098566	hátsó panel top ph2003	n1040309	
003	C00098566				brezil back top	n1040309 n1040336	
003	C00112632				back panel tl evoii	n1040336	
004	C00083901				wire protection		
005	C00083774			1 x C00084913	side panel right top ph2001		
006	C00083787			1 x C00196002	top lengéscsillapító 120n top		
007	C00055037				expander 'w405pwf'	n1040414	
007	C00118593				expander		
009	C00083788				lábrögzítő anya		
010	C00059869				láb rugó d =11 mm h = 21 mm		
011	C00083789				top láb ph2001 m8 h= 29 mm		
014	C00083786				anya ro-mob m6 d.28 1.5top		
015	C00083785			1 x C00093539	mobil alátét top ph2001		
016	C00083780				bútor oldal tömb top ph2001		
017	C00083790				lábazat ph2001 tl		
018	C00065071				oldallap profil 'atl-(90701)-ph'		
019	C00085462			1 x C00117345	elülső panel top ph2001		
020	C00083776			1 x C00084913	side panel left top ph2001		
021	C00041575				adhesive hook		

1250210

Robbantott ábrák

Matr.30519.0001



1250210

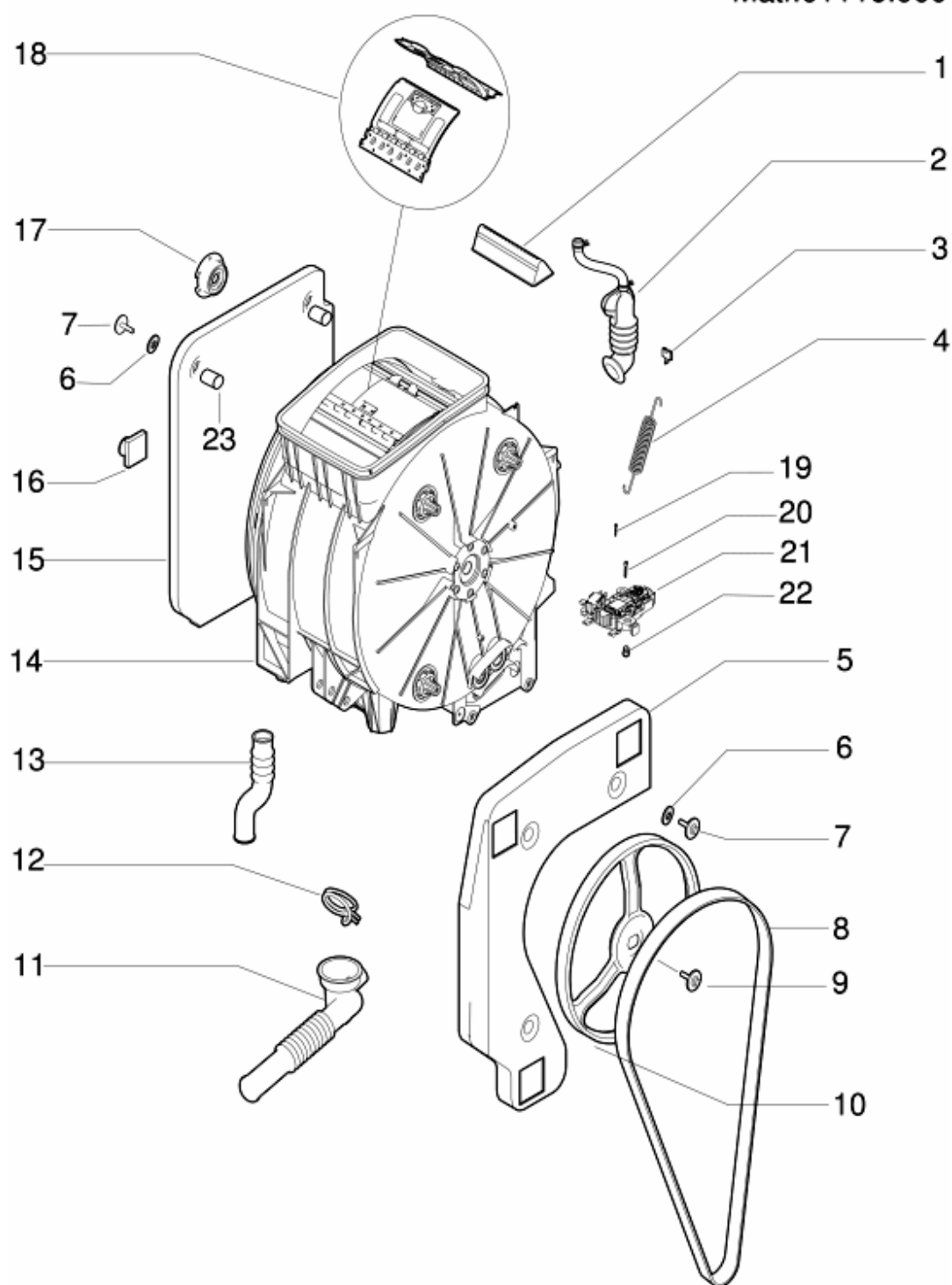
alkatrész lista

refer	Kód	Az S/N	To S/N	Helyettesít	Leírás	jegyzet	ipari kód
001	C00083801				timer kezelőszerv tl ph2001		
002	C00083800				timer kezelőszerv alátét tl ph2001		
003	C00083802				részegységek kezelőszerv tl		
004	C00083804				support knob tl ph2001		
005	C00083803				kapcsoló gomb b27 tl ph2001		
006	C00086331				vezérlő panel wt100csi indesit		
007	C00075456				led égő piros f. csöves 230v	n1040275	
007	C00084763				piros led egység 12v rast 2.5		
007	C00089024				led égő piros 230v ra2,5 antilum-		
008	C00083916				elbi 1665 rast.2 8 pos.tl ph20		
009	C00084985				fedél fogantyú indesit fehér tl		
010	C00085608				fedél egység indesit bremb fehér	N1040346	
011	C00083918				adagoló kioldó kar		
012	C00083922				adagoló beakasztó rugó tl ph2001		
013	C00084983			1 x C00116868	adagoló kioldó gomb fehér27 ph		
014	C00031331				rögzített bilincs cső 'philco'		
015	C00087073				rugó tartó egység tl ariston 2001		
016	C00085468				tl ph2001 alsó fedél	N1040346	
017	C00057933				hátsó feszültség gyűrű '80824'		
018	C00085611			1 x C00111495	membrán tl ph2001	N1040346	
						n1040330	
019	C00083924			1 x C00116866	membrán védelem fehér27 tl		
020	C00084343			1 x C00116869	adagoló fehér27 tl ph2001		
021	C00085610				mikrokésleltető 'bitron' tl ph2001	n1040332	
021	C00111494				mikrokésleltető tl evoii	n1040332	
022	C00084359				szifon fedél tl ph2001		
024	C00083893				screw4x12 tc-t15 tl ph2001		
026	C00063971				kapcsoló (unipolar) on-off		
026	C00075445				kapcsoló alaphelyzetben nyitott	n1040229	
						n1040275	
026	C00083904			1 x C00058465	push button switch bip. na tl	n1040275	
026	C00088394				kapcsoló alaphelyzetben nyitott		
034	C00082331				zavarcsökkentő szűrő 'n842xp'		
035	C00083905			1 x C00085195	potentiometer 8 pos. idc		

1250310

## Robbantott ábrák

Matr.01116.000.



1250310

1250310

alkatrész lista

refer	Kód	Az S/N	To S/N	Helyettesít	Leírás	jegyzet	ipari kód
001	C00051504				továbbító 'atl53txfr-ph'		
001	C00051510			1 x C00083894	továbbító súllyal' atl53txfr-ph'	n1040222	
002	C00085471				légtelenítő cső egység tl ph2001	n1040336	
002	C00112602				steam exhaust hose tl evoii	n1040336	
003	C00065320				rugó gyűrű 'tx90-phil'		
004	C00083798				suspension spring - tank tl ph2001	n1040217	
004	C00085463				tartály elülső rugó tl ph2001		
005	C00083794				jobb ellensúly tl ph2001		
006	C00041605				csészés alátét 'wdp2001x-phil'		
007	C00083797				csavar sw. 8x27 tc-t30tl ph2001		
008	C00083910				rugalmas ékszíj pvel 1213h8 tl		
009	C00065076			1 x C00064786	vezetett tárcsa csavar		
010	C00083912				vezetett tárcsa d280 p21,2 tl	n1040404	
010	C00142832				vezetett tárcsa d280 tl ph2001		
011	C00083898				tartály-szűrő cső tl ph2001	n1040332	
011	C00111502				hose tank to filter oko tl evoii	n1040332	
012	C00074054				kapocs szivattyú tartály cső 'ph'		
013	C00055328				mosószer visszanyerő cső 'ph'	n1040332	
014	C00083805			1 x C00110148 1 x C00110152	műanyag tartály 'tl 600/1000'	n1040324	
014	C00110152			1 x C00111409 1 x C00111505	műanyag tartály 600/1000 tl2004	n1040324 n1040332 n1040340	
014	C00111505				műanyag tartály 600/1000 tl evoii	n1040332	
015	C00083896				bal ellensúly tl ph2001		
016	C00055303				hangszigetelő ütköző		
017	C00055317			1 x C00087966	support		
018	C00080691				csavarkészlet 883000	n1040245	
018	C00083895				töltő nyílás 'top loading'	n1040245 n1040344	
018	C00112743				load orifice soft 'tl evoii'	n1040245 n1040344	
099	C00064550				dain hose holder		
099	C00065871				fúratfedő csomagolás 'lvb2000'		
099	C00081629				desc_ric_c00081629		



1250310

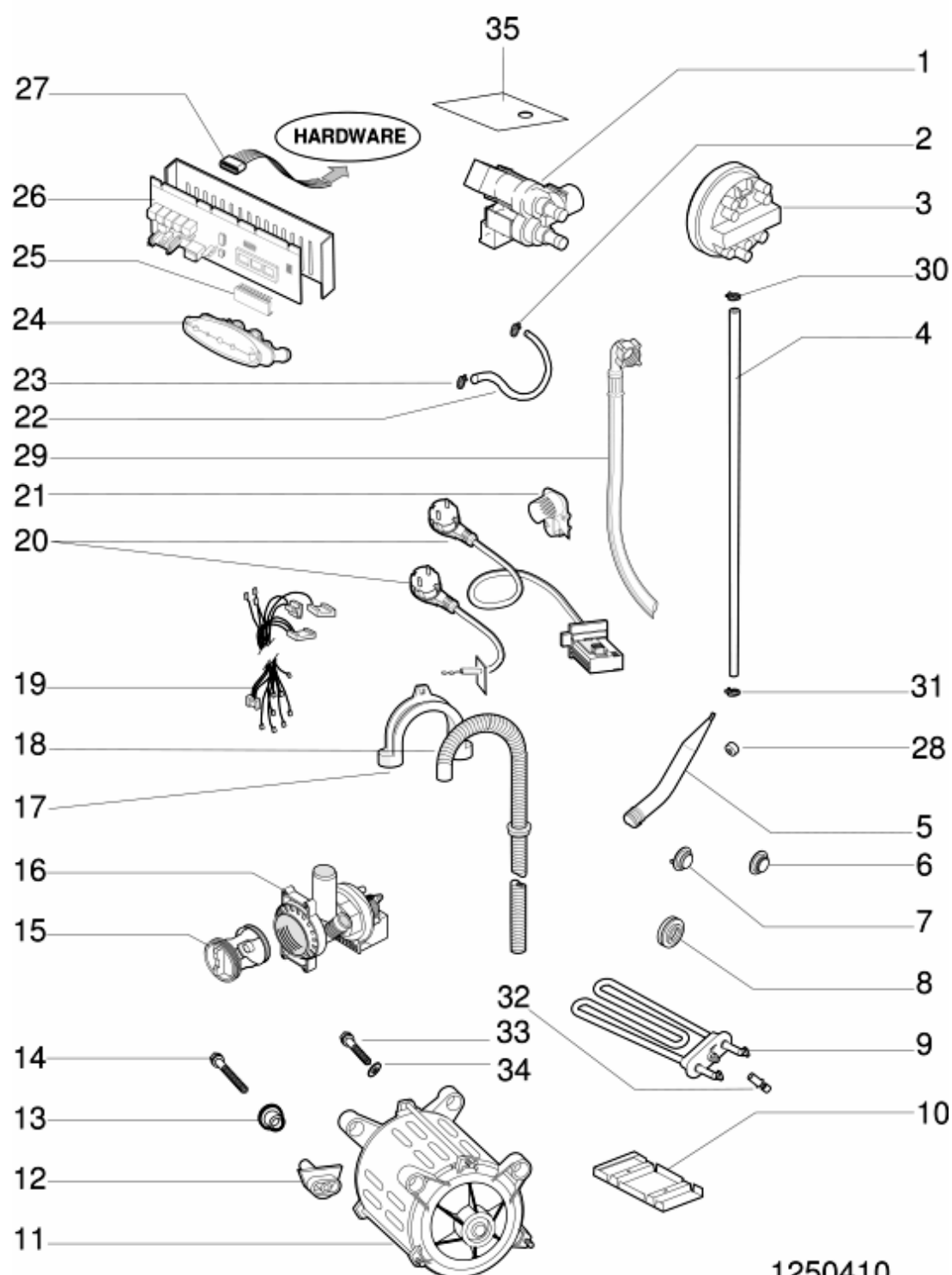
alkatrész lista

refer	Kód	Az S/N	To S/N	Helyettesít	Leírás	jegyzet	ipari kód
099	C00085574				csomagolás készlet tl ph2001	n1040278	
099	C00091902				kit package tl ph2002		

1250410

Robbantott ábrák

Matr. 40408.0001



1250410

1250410

alkatrész lista

refer	Kód	Az S/N	To S/N	Helyettesít	Leírás	jegyzet	ipari kód
001	C00083940				2 utas elektromos szelep 1e-	n1040301 n1040309	
001	C00096350		1 x C00116159		elektromos szelep 1e2u p.2.5	n1040301 n1040309 n1040321	
002	C00061959				binding		
003	C00083903				presszosztát 1+1 szint tl ph2001	n1040332	
003	C00111493				presszosztát 1+1 szint tl evoii	n1040332	
004	C00083897				presszosztát cső tl ph2001		
005	C00051555				levegő csapda 'atl53txfr-ph'	n1040332	
005	C00092173				levegő csapda csőhöz oko	n1040332	
006	C00065412				termosztát furat dugó 'tx60fr-phil'		
007	C00083915				ntc elth tl ph2001 hőmérséklet		
008	C00036072				termosztát tömítés 'phil.70'		
009	C00083906				fűtés ellenállás. 1750w-230v tl	n1040324	
009	C00110148				fűtés ellenállás 1700w-230v tl	n1040324	
010	C00055322				deflector	n1040324	
011	C00098677				motor gyűjtő. ceset p30 tl		
011	C00116645				ceset kollektor motor kefe 6170		
012	C00083911				fixing nut		
013	C00083914				motor rubber bush		
014	C00084333				screw m8x35 tc-t30		
015	C00045027				szivattyú szűrő készlet		
016	C00083942				leeresztő szivattyú askoll 230 tl	n1040332	
016	C00111409		1 x C00141862		leeresztő szivattyú tl evoii	n1040332	
017	C00036145		1 x C00019902		plastic support for drain hose		
018	C00051563				leeresztő cső 'atl53txfr-ph'		
019	C00083900		1 x C00091648		wiring 3m+4t+1l	n1040275	
019	C00091648				vezetékek 3m+4t+1l ibrido tl ph	n1040288 n1040301	
019	C00096434				vezetékek 3m+4t+1l ibrido tl	n1040301 n1040332	
019	C00111538				wiring 3m+4t+2l tl	n1040332	
020	C00083907				tápvezeték 3x1,0 l=1500 tl ph200	n1040288	
020	C00091633				tápvezeték.3x1 schuko		

1250410

alkatrész lista

refer	Kód	Az S/N	To S/N	Helyettesít	Leírás	jegyzet	ipari kód
021	C00083944				légtelenítő cső rács tl ph2001	n1040336	
022	C00083939			1 x C00093620	elosztó szelep cső tl ph2001	n1040309	
022	C00087068			1 x C00093621	tubing valve distributing	n1040309	
022	C00097841				hose fill valve l=145	n1040309	
023	C00054734				kapocs 'atl63txex-ph'		
024	C00083941				elosztó egység tl		
025	C00086326				eprom wt100csi szoftver	n1040061 n1040078	
026	C00083908			1 x C00084838	module (less eeprom) tl ph2001	n1040061 n1040078 n1040321	
027	C00066292				insulated tweezers		
027	C00084566			1 x C00095669	soros kulcs lb2000-pc e top load.		
027	C00084943			1 x C00099862	serial cable lb2000 - pc	n1040211 n1040317	
028	C00078221				tubetto spugn.40x5x30		
029	C00051556			1 x C00003070 1 x C00005572	töltőcső 'atl53txfr-ph'		
030	C00051541				kapocs 'atl53txfr-ph'		
031	C00061958				kapocs d=32,7 'philco'		
035	C00109798			1 x C00116161	elektromos szelep védelem tl	n1040321	

jegyzet

## N1040346: Elimination of leakage between upper top and cover on TL.

---

This modification is applied only after having checked for the absence of distortion or breakage of the components that jointly ensure a watertight seal (cover, top, diaphragm, etc.).

The modification consists in raising the diaphragm to obtain greater interference between diaphragm and cover inner panel.

### PROCEDURE:

Remove the nine screws located under the diaphragm, remove the plastic protection, and raise the diaphragm, positioning it inside the loading port.

After drying the supporting surface apply a strip of approximately 1.2 mm of adhesive expanded rubber, replacement P/N 066834 which has been previously prepared by cutting it in half lengthwise.

## n1040061: Trouble-shooting.

---

Intervention procedure on 2000 washing machines

### 1. Reading the error code

The fault on the appliance is signalled via:

1. the continuous rotation of the selector knob
2. the action, for the first 4', of the electrovalve and the drain pump
3. the door becomes unlocked
4. the led flashes:

the number of flashes indicates the fault code; the code should be read as follows:

- each fast flash (2/3 flashes of the led very close together) represents one code value
- the fault code is evaluated by counting the number of flashes occurring at 3/4" intervals from one another
- stop counting when the washing machine waits the equivalent of approximately 8/9" between flashes
- the procedure is repeated by the appliance cyclically

E.g.: F03



(FIGURE NT 00)

## 2. Autotest

Should the washing machine not be signalling an error, you can check it using a serial key and using a particular autotest cycle, which is to be activated as follows:

1. bring the washing machine to reset position (coloured ball) for at least 5" and wait until the led flashes on reset mode
2. insert the hardware key into the serial outlet
3. position the switch situated on the key in TEST position
4. wait for the door to lock and for the selector to start turning
5. position the switch situated on the key in PC position

the appliance will carry out the following cycle:

- selector moves on up to position 0 (12h if the appliance has a delay, programme 1 if it has no delay)
- loads the wash electrovalve for approx. 10"
- loads the pre-wash electrovalve for approx. 10"
- loads the wash electrovalve and pre-wash electrovalve at the same time until the pressure switch is on full
- heats up to 30° and moves the motor in both directions
- selector moves on for 9 notches
- drains and spins
- the selector knob stops on one of the reset positions
- STOP

The test cycle can be repeated as many times as you wish following the same procedures

The test cycle can be interrupted by positioning the selector knob on one of the reset positions.

## 3. Intervention in the event of a Fault

In the event of a fault, the procedure to go by is as follows:

F01: Triac Short circuit  
Overhaul CNE

Replace Card

F02: Blocked Motor, Short-circuited/Open Tachometry

Overhaul CNE

Overhaul Motor connector

Control CNE Continuity/Motor Connector

Control Motor Windings

Control Tachometry Windings

Replace Card

F03: Open/Short-Circuited NTC Found

Overhaul CNA

Control NTC Wiring

Control CNA/NTC Wiring Continuity

Replace NTC

Replace Card

F04: Overflow and Pressure Switch Empty found at the same time (Pressure Switch stuck on Empty)

Overhaul CN1

Overhaul Pressure Switch Contacts

Control CN1/Pressure Switch Continuity

Replace Pressure Switch

Replace Card

F05: Blocked Pump or Pressure Switch stuck on Empty Found

Overhaul CNF (pump connector)

Overhaul Pump Connector

Control Pump Filter

Control Pump Windings

Change Pump

Replace Card

F06: Selector Error (a part no. cannot be found)

Overhaul CND (selector connector)

Overhaul Selector Connector

Control Selector/CND Continuity

Control Selector Motor

Replace Selector

Replace Card

F07: Resistance Relay Stuck

Overhaul CN1

Overhaul CN1

Overhaul Resistance Connection

Replace Card

Overhaul Resistance Connection

Replace Card

F08: Resistance Missing or Pressure Switch stuck on Full Found

Overhaul CN1

Overhaul Resistance Connection

Overhaul Pressure Switch Connection

Replace Resistance

Replace Pressure Switch

Replace Card

F09: Machine Setup Error Found

## Control Microprocessor Version

Ask for EEPROM Spare Part indicating Microprocessor version

### F10: Pressure Switch Empty and Full or neither Empty nor Full Pressure Switch Found

Overhaul CN1

Overhaul Pressure Switch Wiring

Control CN1/Pressure Switch Continuity

Replace Pressure Switch

Replace Card

### F11: Pump Feedback Missing

Overhaul CN1

Overhaul CNF

Overhaul Pump Connector

Overhaul Pressure Switch Connector

Control Pump Windings

Replace Pump

Replace Card

### F12 SPECIFIC FOR LVB2000 INDESIT EVOLUTION / DIALOGIC.

#### F12: Lack of Display card-Main Card Communication

1. Check the effectiveness of contacts on CNC Connector Card
2. Overhaul 8-way connector on Display card
3. Check continuity of CNC-CN 8 way connector
4. Replace Main Card
5. Replace Display Card

### F13: NTC wiring harness disconnected from the dryer system

1. Check the efficiency of the terminals on the CNA connector board
2. Check NTC wiring harness
3. Check the wiring harness continuity of the CNA / NTC connectors
4. Replace NTC
5. Replace terminal board

### F14: Dryer connector open or not connected

1. Check the efficiency of the terminals on the CNI connector board
2. Overhaul CN1
3. Overhaul connector connection
4. Replace the board.Merloni Elettrodomestici

### F15: Dryer connector is always active

1. Check the efficiency of the terminals on the CNI connector board
2. Overhaul connector connection
3. Overhaul the pressure sensor connection
4. Replace the connector
5. Replace pressure sensor
6. Replace the board

### F16: Non-functioning basket block

1. Go over connector card CNC
2. Go over connector basket block
3. Control Continuity of cabling CNC / basket block and basket block supply
4. Replace basket block
5. Replace card

N.B.From Fault F01 to fault F11



These are shown by LEDs in stand by/on in LVB2000 machines Ariston/Indesit.  
From fault F01 to fault F12  
These are shown in a display located on the instrument panel of LVB2000 machines Evolution Indesit.  
From fault F01 to fault F15  
Are those that are indicated according to the version via LED stand by/on or display positioned on the Wash Dry machine Ariston/Indesit panel.

#### 4. Replacing the card

Should you have to replace the card:

- retrieve the EEPROM from the old card
- reassemble the EEPROM onto the new replacement card (without EEPROM)

In the event, and only in this case:

- an F02 has been detected
- the above-mentioned checks have been carried out and no problems have been detected on the wiring or to the motor
- the card fitted onto the washing machine is a 12 or 20 version (the version is indicated by a label on the module-containing box with SW20 or SW12)

you should:

- fit on a new card (version 32 or above)
- fit on an updated EEPROM to request from the assistance service centre, stating the code (e.g. 80xxxxx0000 or 46xxxxx0000), the serial number and the washing machine model.

#### n1040078: WARNING: Remove the eeprom

---

Remove the eeprom with pliers part no. 066292 from the faulty module and insert it on the new module / display module, otherwise the machine will not function.

L'EPROM contains the software that characterizes the model, therefore each apparatus should have his own specific eeprom(see the list spare parts).

#### n1040211: Serial cable to connect the hardware key with the PC.

---

To connect the hardware key: LB2000 with the personal computer, you must use a serial cable, pin to pin 9 pin F/F, to guarantee the availability, it was decided to manage it as a spare part.

The SAT code of the cable (length 2m) is 084943.

#### n1040217: Introduction of new front springs for tank suspension

---

From the register number 110120001 new front springs for tank suspension code 085463 are introduced on washing-machines with top loading, produced in the plant of Brembate, for needs of production.  
The two back springs are the pre-modified ones (cod. 083798).

#### n1040222: Introduced new clothes dragger with Brembate top loader weight

---

From the 201100001 registration number on the Washing machines loaded from the top produced in the Brembate establishment (Top Loader 2001), a new clothes dragger has been introduced with the weight code 083894.  
The new particular can be mounted replacing the premodify (051510), but not vice versa. The premodify dragger will continue being regularly managed from exchange warehouse as it is employed in other productions.

#### n1040245: Brembate washing machine basket doors re

---

For all washing machine models produced in the Brembate factory and relevant to this note, in replacing the loading mouth code 083895/112743 proceed as follows:

- remove the 18 rivets (9 on the right, 9 on the left) hooking the two doors to the loading mouth on the machine;
- take replacement part 083895/112743 and carry out the same operation described in the previous point;
- hook the two new doors and the new loading mouth on the basket of the machine using the nut and bolts kit code 080691 (formed of 18 screws + 18 washers + 18 nuts);
- use silicone (SAT code 081629) for hooking the loading mouth on the basket.

#### n1040275: Modification of lamp-switches on TOP washing machines

---

From serial no. 20916.0001 the wiring assembly has been modified on top-load washing machines produced in the Brembate factory, due to introduction of the following parts:

- 1)SINGLE-POLE 063971 in place of TWO-POLE 083904;
- 2)NA IDC 088394 in place of NA 075445;
- 3)INDICATOR LAMP IDC 089024 in place of INDICATOR LAMP 075456.

Wiring assemblies:

Old 083900 - new 091648

Old 085543 - new 091649

Old 090926 - new 091650

The machines fitted with the wiring assemblies listed below only have a switch modification because they are not fitted with the indicator lamp.

Wiring assemblies:

Old 084880 - new 091651

Old 087118 - new 091652

Old 087915 - new 091653

Old 088303 - new 091654

The modification also involved the wiring diagram and the wiring layout; the new layouts are differentiated from the old ones by means of the start of validity date: 16/09/02.

The new wiring assemblies can also be fitted on premodification machines, therefore the old ones will be managed until stocks run out.

### n1040278: New packing kit on Brembate TOP washing machines

---

From serial no. 21022.0001, a new packing kit Sat code 091902 (in place of Sat code 085574) and a new rear panel Sat code 091893 (in place of Sat code 083784) have been introduced on top-load washing machines produced in the Brembate factory. This modification has introduced the packing hole cover Sat code 065871 and the drain tube support code 064550.

### n1040288: Power supply cable + moulded filter on top-load Brembate WMs

---

From serial number 30224.0001, all top-load washing machines produced in the Brembate factory have been equipped with a new power supply cable with moulded filter and new rear panels with a specific opening for fixing the new cable.

The new power supply cables are:

Sat code 091632 Power supply cable 3x1 schuko 1.5m+capacitance filter;

Sat code 091633 Power supply cable 3x1 schuko 1.5m+inductive filter;

Sat code 091641 Power supply cable l=2550mm ag +capacitance filter;

Sat code 091635 Power supply cable uk 3x1 l=1950mm+capacitance filter;

Sat code 091634 Power supply cable uk 3x1 l= 1950mm + inductive filter;

Sat code 091689 Power supply cable l=2550mm ag +inductive filter.

The new rear panels are:

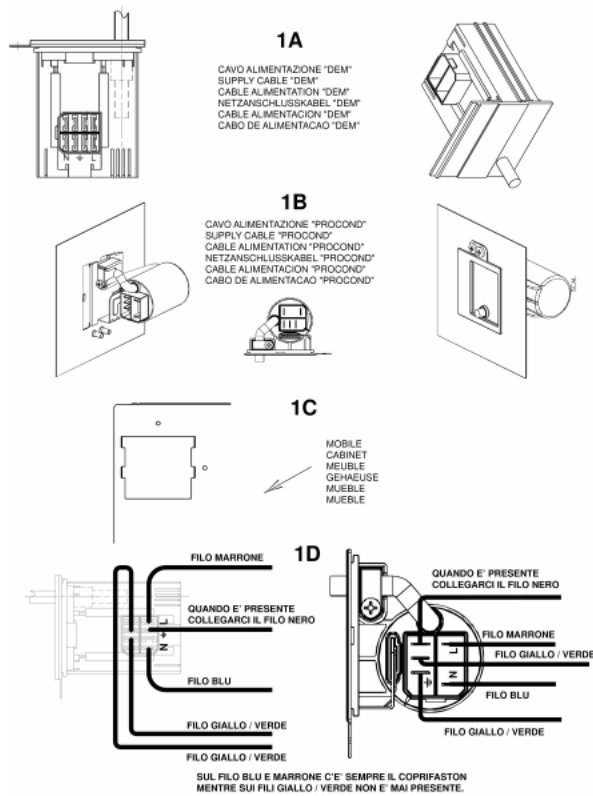
Sat code 094067 - premodification Sat code 091893 (used for few months in place of code 083784, see N1040278);

Sat code 094068 - premodification Sat code 093623 (specific for the Hotpoint WMTL80UK model, commercial code 28749).

To use premodified wirings on modified products perform the connection to the terminal block of the new cable as shown in fig. 1 - 1D.

The wiring diagrams indicated in the Documentation remain the same.

FIG. 1



## n1040301: Modification of solenoid valves and wiring on Brembate TOP LOAD washing machines

From serial number 30609.0001, the top-load washing machines affected by this note have been equipped with the solenoid valve with coil rast 2.5 Sat code 096350 in place of 083940.

This modification does not affect model WMTL80UK commercial code 28749, which has been equipped with solenoid valves Sat code 096350 (1E2U) and 096349 (1E1U) in place of 083940 (1E2U) and 093546 (1E1U).

The wiring harnesses have been modified therefore both the premodification and new ones will be managed; the wiring diagrams are unchanged.

The Sat codes are given below:

Sat code new 096426 premodification 087487;  
Sat code new 096427 premodification 087703;  
Sat code new 096428 premodification 088098;  
Sat code new 096429 premodification 088127;  
Sat code new 096431 premodification 088292;  
Sat code new 096432 premodification 090240;  
Sat code new 096433 premodification 088027;  
Sat code new 096434 premodification 091648;  
Sat code new 096436 premodification 091651;  
Sat code new 096437 premodification 091649;  
Sat code new 096438 premodification 091652;  
Sat code new 096440 premodification 091653;  
Sat code new 096452 premodification 093540;  
Sat code new 096441 premodification 090610;  
Sat code new 096451 premodification 087928;  
Sat code new 096444 premodification 091650;  
Sat code new 096445 premodification 091654.

The models affected by this modification are:

26376 WT60FR  
26867 WT62EX  
26377 WT62TFR  
26450 WT6IT  
26454 WT5IT  
26451 WT4IT  
26894 WT52CSI  
26865 WT40EX  
26866 WT50EX  
28672 WT124FR  
28075 WT120EX  
26868 WT82EXP  
26379 WT82TFR  
26452 WAT6IT  
26453 WAT8IT  
27872 W4608TLCSI  
26899 WT100CSI  
26869 WT102EXP  
27728 WT102TFR  
28670 WT92FR  
28671 WT112FR  
28314 WAT10IT  
27873 W4610TLCSI  
28669 WT80FR  
26897 WT80CSI  
26970 WT67EU  
27143 AT82IT  
28491 AT125FR  
29395 AT110FR  
27122 AT85FR  
29388 AT95FR  
29182 AT109FR  
27142 AT62IT  
28749 WMTL80UK  
29393 ATD102FR  
27148 ATD120EX  
27125 ATD120FR  
29394 ATD122FR  
27636 ATD104EX  
27145 ATD104IT  
27144 ATD84IT  
26898 WT90CSI  
27635 AT84EX  
28074 AT104EX  
27726 AT84EO  
27684 AT84AG

The wiring diagrams are unchanged.

n1040309: Modification of rear panels on TOP LOADING washing machines.

---

From serial no. 30912.0001, the system used for fixing the loading solenoid valve (spare part code 096350) to the rear panel has been modified on Top Loading washing machines, rotating its position by 90°.

The solenoid valve (spare part code 096350) has been modified with the 45° rotation of a coil; the Replacements Warehouse will continue to manage this part with the same code. When replacing on premodification machines, fit the coils as shown in figure N1040309FIG3-1 and on modified machines, as shown in figure N1040309FIG3-2; to rotate the coil, lift it using a screwdriver and then refit according to the inserts on the plastic.

Replacement codes of the parts affected by this modification (see figure N1040309FIG1):

#### FIG1 A - PREMODIFICATION STRUCTURE

solenoid valve tube/distributor assembly: premodification 083939;

solenoid valve tube/distributor assembly: premodification 087068;

rear panel: premodification 094067.

#### FIG1 B - NEW STRUCTURE

solenoid valve tube/distributor assembly: new 097841;

solenoid valve tube/distributor assembly: new 097841;

rear panel: new 098566.

Replacement codes of the parts affected by the modification to WMTL80UK (see figure N1040309FIG2):

#### FIG2 A - PREMODIFICATION STRUCTURE

solenoid valve tube/distributor assembly: premodification 093620;

solenoid valve tube/distributor assembly: premodification 093621;

rear panel: premodification 094068.

#### FIG2 B - NEW STRUCTURE

solenoid valve tube/distributor assembly: new 097832;

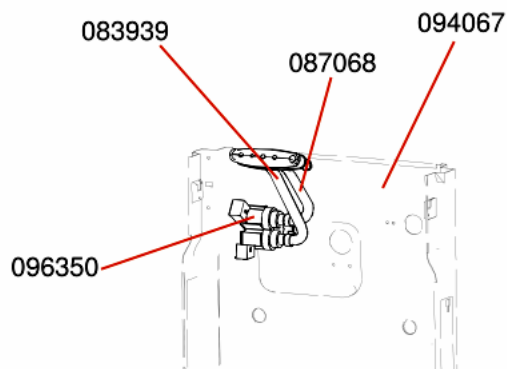
solenoid valve tube/distributor assembly: new 097832;

rear panel: new 098567.

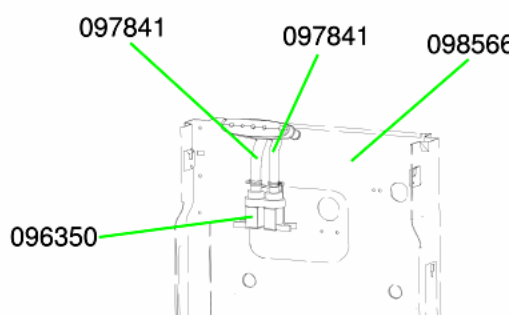
Premodification panels will be managed by the Replacements Warehouse while stocks last; when replacing with new ones on premodification appliances the new tubes must also be used.

When using the new panels on appliances before serial no. 30609.0001, fitted with solenoid valve code 083940, rotate the coil 45° and follow the instructions given above for code 096350, paying attention during the wiring phase to keep the cables away from the bowl support spring.

N1040309FIG1

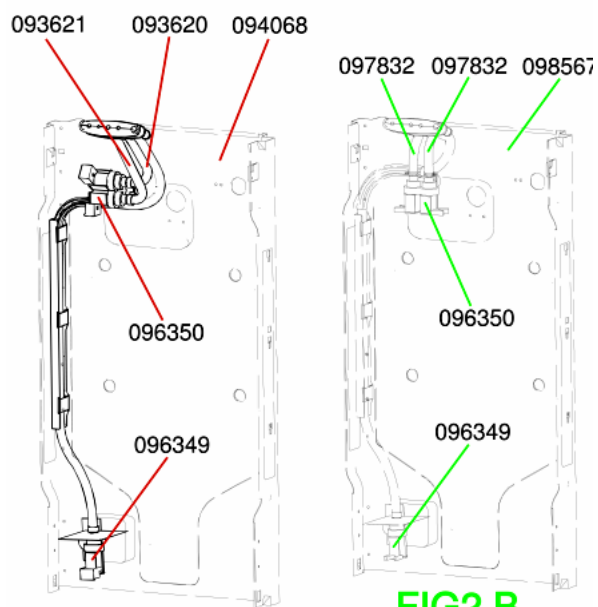


**FIG1 A**



**FIG1 B**

N1040309FIG2



**FIG2 A**

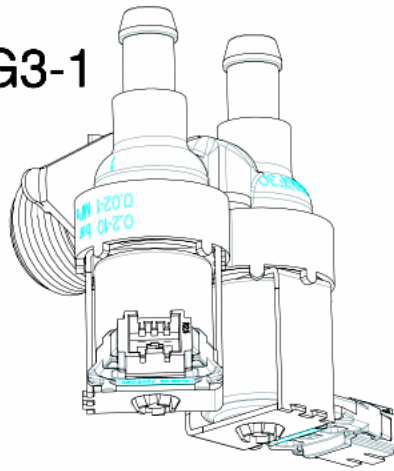
**FIG2 B**

n1040321: Plastic protection for solenoid valve.

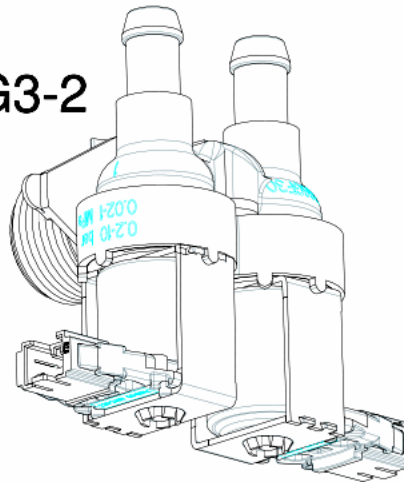
---

All top-load washing machines produced from September 2003 to February 2004 (from serial no. 30900.0000 to 40300.0000)

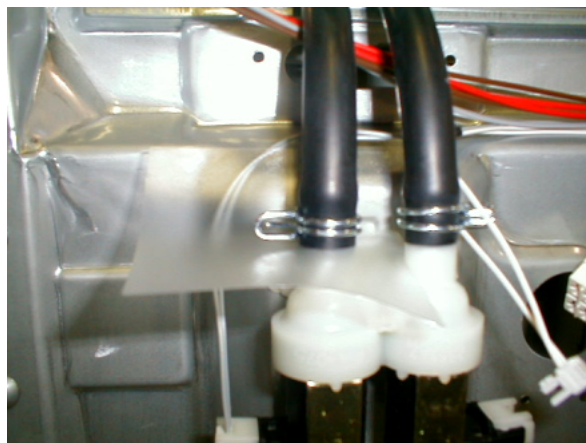
**FIG3-1**



**FIG3-2**



have been equipped with a plastic protection Service code 109798 (shown in N1040321FIG1), to prevent water from damaging the solenoid valve and electronic card.



n1040324: Modification of heater fixing system on top-load washing machines.

---



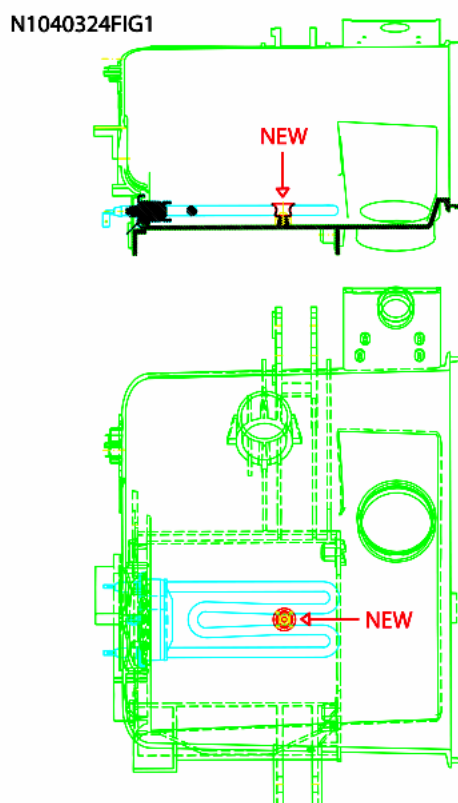
From serial number 40506.0001, the fixing system of the heater to the tank has been modified on all top-load washing machines affected by this note, with the introduction of a metal retainer (image N1040322FIG1 reference NEW) in place of deflector Service code 055322.

The modification has involved both heater and tanks. Given below are the Service codes of the new and old items concerned:

-PLASTIC TANK FOR 600-1000 RPM MACHINES: new 110152, premodification 083805;

-PLASTIC TANK FOR 1200 RPM MACHINES: new 110153, premodification 092023;

-HEATER: new 110148, premodification 083906.



#### n1040332: 'Evizzazione' of top-load washing machines produced in Brembate

---

From serial no. 40628.0001, the following items have been modified on all top-load washing machines affected by this note:

##### PLASTIC TANK

800/1000 rpm machines: premodification 110152 - new 111505

1200 rpm machines: premodification 110153 - new 111573

##### PUMP BOWL TUBE

premodification 083898 - new 111502 (OKO PUMP BOWL TUBE)

##### AIR TRAP

premodification 051555 - new 092173

#### MICRO DELAY DEVICE

premodification 085610 - new 111494

#### DRAIN PUMP

premodification 083942 - new 111409

#### PRESSURE SWITCH

premodification 087499 - new 111514

premodification 087704 - new 111516

premodification 083903 - new 111493

#### WIRING

#### ELIMINATION OF DETERGENT RECOVERY TUBE code 055328

The modification has involved the introduction of a new industrial code with final 30.

Given below is the list of affected models with related industrial codes and spare part codes of modified wirings:

WT60FR (91263760000 - 91263760030):

Wiring: premodification 096426 - new 111515

WT62TFR (91263770000 - 91263770030):

Wiring: premodification 096427 - new 111517

WT6IT (91264500000 - 91264500030):

Wiring: premodification 096428 - new 111523

WT4IT (91264510000 - 91264510030):

Wiring: premodification 096429 - new 111529

WAT6IT (91264520030 - 91264520000):

Wiring: premodification 096434 - new 111538

WAT8IT (91264530030 - 91264530000):

Wiring: premodification 096434 - new 111538

WT5IT (91264540030 - 91264540000):

Wiring: premodification 096428 - new 111523

WT40EX (91268650030 - 91268650000):

Wiring: premodification 096432 - new 111515

WT50EX (91268660130 - 91268660100):

Wiring: premodification 096433 - new 111529

WT62EX (91268670230 - 91268670200):

Wiring: premodification 096427 - new 111517

WT82EX (91268680130 - 91268680100):

Wiring: premodification 096434 - new 111538

WT102EX (91268690130 - 91268690100):

Wiring: premodification 096434 - new 111538

WT52CSI (91268940130 - 91268940100):

Wiring: premodification 096431 - new 111551

WT80CSI (91268970130 - 91268970100):

Wiring: premodification 096437 - new 111555

WT90CSI (91268980130 - 91268980100):

Wiring: premodification 096444 - new 111561

WT100CSI (91268990130 - 91268990100):

Wiring: premodification 096434 - new 111538

WT67EU (91269700030 - 91269700000):

Wiring: premodification 096437 - new 111555

AT62IT (91271420030 - 91271420000):

Wiring: premodification 096440 - new 111568

AT82IT (91271430030 - 91271430000):

Wiring: premodification 096438 - new 111569

ATD84IT (91271440030 - 91271440000):  
Wiring: premodification 096451 - new 111571  
ATD104IT (91271450030 - 91271450000):  
Wiring: premodification 096451 - new 111571  
ATD120EX (91271480130 - 91271480100):  
Wiring: premodification 096451 - new 111571  
AT50EX (91272040130 - 91272040100):  
Wiring: premodification 088264 - new 111505  
AT84EX (91276350130 - 91276350100):  
Wiring: premodification 096445 - new 111580  
ATD104EX (91276360130 - 91276360100):  
Wiring: premodification 096451 - new 111571  
AT64EX (91276740030 - 91276740000):  
Wiring: premodification 088264 - new 111579  
AT84AG (91276840030 - 91276840000):  
Wiring: premodification 096445 - new 111580  
AT84EO (91277260030 - 91277260000):  
Wiring: premodification 096445 - new 111580  
WT102TFR (91277280030 - 91277280000):  
Wiring: premodification 096434 - new 111538  
AT64EO (91277540030 - 91277540000):  
Wiring: premodification 088264 - new 111579  
AT50AG (91277630030 - 91277630000):  
Wiring: premodification 088264 - new 111579  
W46.08TLCSE (91278720030 - 91278720000):  
Wiring: premodification 096434 - new 111538  
W46.10TLCSE (91278730030 - 91278730000):  
Wiring: premodification 096434 - new 111538  
AT104EX (91280740030 - 91280740000):  
Wiring: premodification 096445 - new 111580  
WT120EX (91280750030 - 91280750000):  
Wiring: premodification 096434 - new 111538  
WAT10IT (91283140030 - 91283140000):  
Wiring: premodification 096434 - new 111538  
AT125FR (91284910030 - 91284910000):  
Wiring: premodification 096438 - new 111569  
WT80FR (91286690030 - 91286690000):  
Wiring: premodification 096436 - new 112221  
WT92FR (91286700030 - 91286700000):  
Wiring: premodification 096434 - new 111538  
WT112FR (91286710030 - 91286710000):  
Wiring: premodification 096434 - new 111538  
WT124FR (91286720030 - 91286720000):  
Wiring: premodification 096434 - new 111538  
WMTL80UK (91287490030 - 91287490000):  
Wiring: premodification 096542 - new 112231  
AT109FR (91291820030 - 91291820000):  
Wiring: premodification 096438 - new 111569  
AT95FR (91293880030 - 91293880000):  
Wiring: premodification 096438 - new 111569  
ATD102FR (91293930030 - 91293930000):  
Wiring: premodification 096441 - new 112235  
ATD122FR (91293940030 - 91293940000):  
Wiring: premodification 096451 - new 111571  
AT110FR (91293950030 - 91293950000):  
Wiring: premodification 096438 - new 111569  
WT100FR (91305060030 - 91305060000):

Wiring: premodification 096436 - new 112221  
WT118FR (91305080030 - 91305080000):  
Wiring: premodification 096434 - new 111538  
AT8EIT (91306100030 - 91306100000):  
Wiring: premodification 096438 - new 111569  
WT119FR (91319910030 - 91319910000):  
Wiring: premodification 096434 - new 111538

#### n1040336: Elimination of vent from rear panel of top-load washing machines.

From serial no. 40825.0001, the vent tube has been modified with the elimination of the vent from the rear panel of all top-load washing machines affected by this note (see photo N1040336FIG1).

Given below are the codes of the modified items:

- Vent tube: premodification 085471 new 112602;
- Rear panel: premodification 098566 new 112632;
- Vent grid code 083944 has been eliminated.

N1040336FIG1



#### n1040340: TUB ASSEMBLY 111505 - 111573 (EVO II) ON EVOI TOP LOADING APPLIANCES

---

Given below are the instructions to install the new EVOII Top Loading tubs (codes 111505 and 111573) on EVOI Top Loading washing machines produced before serial no. 40628.0001 (see note n1040332).

Please note that:

the EVOI Top Loading range tubs (spare part codes 110152-110153) are no longer managed as spare parts and have been replaced as follows:

if you order code 110152 (EVOI T.L. 600-1000 RPM TUB) you will receive in its place:

- 111505: EVOII T.L. 600-1000 RPM TUB
- 111409: EVOII T.L. DRAIN PUMP

if you order code 110153 (EVOI T.L. 1200 RPM TUB) you will receive in its place:

- 111573: EVOII T.L. 1200 RPM TUB-BASKET ASSEMBLY
- 111409: EVOII T.L. DRAIN PUMP

Proceed as follows:

- 1) Replace the EVOI DRAIN PUMP with the new EVOII DRAIN PUMP - 111409;
- 2) Eliminate the DETERGENT RECOVERY TUBE (the new tub and new pump are not provided with the corresponding hole);
- 3) Do not remove the VENT TUBE that is on the appliance (the one on the new EVOII tub-basket assembly is no longer provided with the vent on the rear panel).

Given below are the models affected:

26376 - WT60FR  
26377 - WT62TFR  
26450 - WT6IT  
26451 - WT4IT  
26452 - WAT6IT  
26453 - WAT8IT  
26454 - WT5IT  
26865 - WT40EX  
26866 - WT50EX  
26867 - WT62EX  
26868 - WT82EX  
26869 - WT102EX  
26894 - WT52CSI  
26897 - WT80CSI  
26898 - WT90CSI  
26899 - WT100CSI  
26970 - WT67EU  
27142 - AT62IT  
27143 - AT82IT  
27144 - ATD84IT  
27145 - ATD104IT  
27148 - ATD120EX  
27204 - AT50EX  
27635 - AT84EX  
27636 - ATD104EX  
27674 - AT64EX  
27684 - AT84AG  
27726 - AT84EO  
27728 - WT102TFR  
27754 - AT64EO

mod.WT100CSI

27763 - AT50AG  
27872 - W46.08TLCSI  
27873 - W46.10TLCSI  
28074 - AT104EX  
28075 - WT120EX  
28314 - WAT10IT  
28491 - AT125FR  
28669 - WT80FR  
28670 - WT92FR  
28671 - WT112FR  
28672 - WT124FR  
28749 - WMTL80UK  
29182 - AT109FR  
29388 - AT95FR  
29393 - ATD102FR  
29394 - ATD122FR  
29395 - AT110FR  
30506 - WT100FR  
30508 - WT118FR  
30610 - AT8EIT  
31991 - WT119FR

#### n1040344: Modification of loading port on Top Loading washing machines.

---

The loading port with replacement P/N 112743 has been installed on the models affected by the current bulletin from serial number 41119.0001; the new port is not interchangeable with premodification P/N 083895.

The commercial code and the code of affected models are given below.

26376WT60FR  
26377WT62TFR  
26451WT4IT  
26452WAT6IT  
26453WAT8IT  
26454WT5IT  
26865WT40EX  
26866WT50EX  
26867WT62EX  
26868WT82EX  
26869WT102EX  
26894WT52CSI  
26897WT80CSI  
26898WT90CSI  
26899WT100CSI  
26970WT67EU  
27145ATD104IT  
27636ATD104EX  
27728WT102TFR  
27763AT50AG  
27872W46.08TLCSI

28074AT104EX  
28314WAT10IT  
28670WT92FR  
28749WMTL80UK  
30506WT100FR  
30610AT8EIT  
33194AVTL62EU  
33195AVTL82EU  
33196AVTL83EU  
33198AVTL104EU  
33686AVTL60AG  
33738AVTL60EO  
33739AVTL84EO  
33807AVTL62IT  
33915WITL85FR  
33916WITL88FR  
33917WITL90FR  
33918WITL100FR  
33969AVTL108FR  
34265WITP82EU  
34266WITP102EU  
34267WITL105EU  
34269WITE87EU  
34280WITL85EU

n1040404: A Top Loadingon 1000 fordulatig új tárcsa lett bevezetve (NINCS dobblakk).

---

Az 51202.0001 gyári számtól a tárcsa futása 21,2mm-ről 24,2mm-re lett növelve (lásd az N1040404FIG1 képet).

Új tárcsa

C00142832 - D280 24,2 mm-es menet

Módosítás előtti tárcsa

C00083912 - D280 21,2 mm-es menet

Az új tárcsát a jelen értesítés által érintett modellek módosítás előtti változatain is lehet alkalmazni.

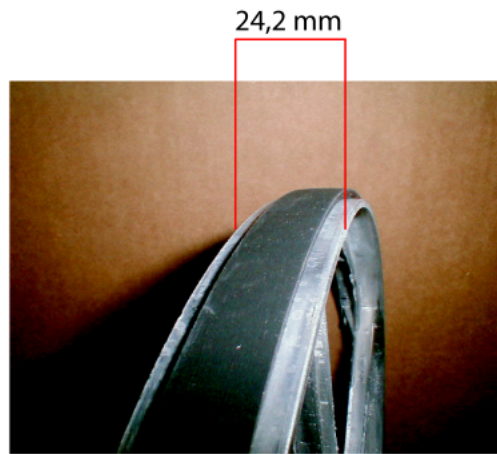
n1040414: Új expander bevezetése a brembatei felültöltős mosógépen.

---

Az 50213.0001 gyári számtól a C00118593 expander lett bevezetve a C00055037 helyett.

Az újat a jelen értesítés által érintett modellek módosítás előtti változatain is lehet alkalmazni.

N1040404FIG1

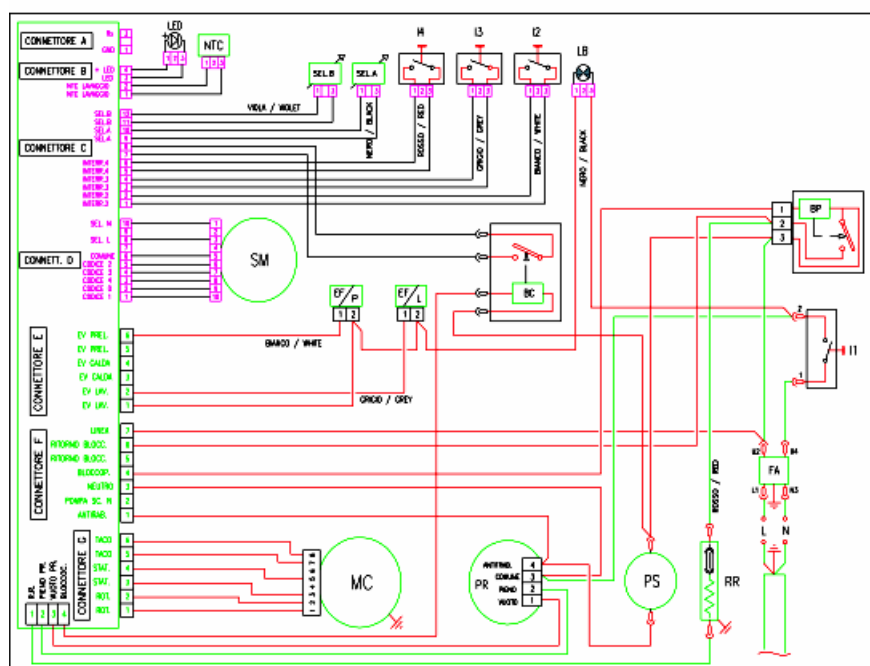
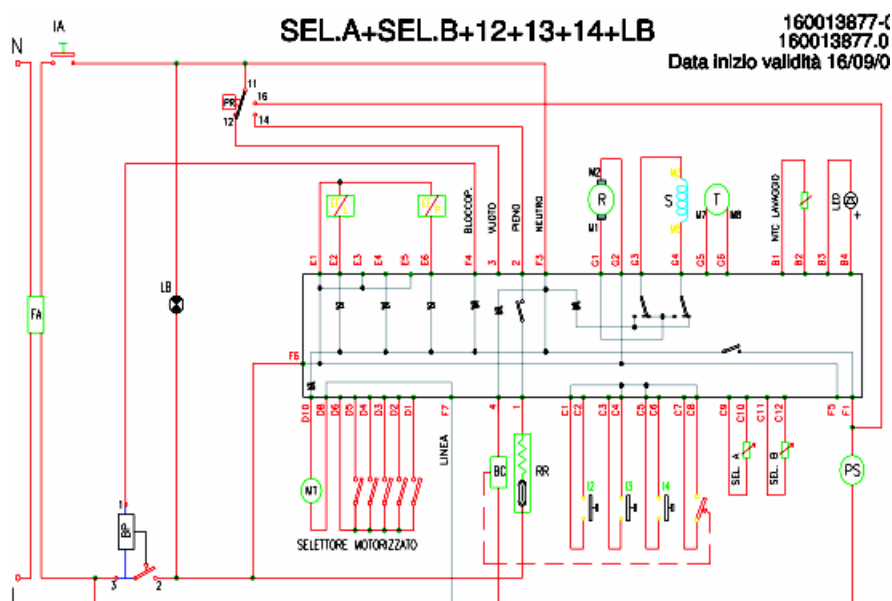




csatlakozások

Cod. 160013877-0

Elektromos ábrák és



## leírás

leírás: 160013877-0

AQS	Aquastop electrovalve	Mzbn/MTA	zbn timer motor
B	Buzzer	N	Neutral or Terminal Board
BC	Blocco Cesto	NC	Spin cycle exclusion
BF	Terminal board contact, motor fan and dryer	P	Pressure switch
BP	Buzzer	P1	1st level pressure cut-off switch
C	Condensator	P2	2nd level pressure cut-off switch
CA	Condensator	PA	High speed potentiometer
DV	Switching device	PB	Low speed potentiometer
EF/CL	Electro-Valve Cold Water / Bleach	PL	Pure Wool
EF/L	Electro-Valve Cold Water / Wash	PM	Motor Thermoprotector
EF/P	Electro-Valve Cold Water / Prewash	PR	Timer programmer or Pressure switch
ER	Exclude Heating Element	PS	Drain pump
ET	Thermostat disactivation	R	Heating element
EV	Electrovalve	RE	Relay
EVA	Dryer electrovalve	RR	Heating element
EVC	Hot water electrovalve	RV	Speed regulator
EVF	Elettrovalvola acqua fredda	Ras/RA	Dryer heating element
EVL	Wash electrovalve	S	LED
EVP	Pre Wash electrovalve	SL	Line LED
FA	Antijamming filter	SO	Door LED
FD	Delicate drying cycle thermostat	SR	Heating LED
FE	Strong drying cycle thermostat	ST	Temperature selector
FRT	Thermofusible Heating Element	SV	Speed Selector for Spin
I	Inverter	T	Timer contacts
II..2..3..	Switches/switching devices	TA	Drying timer contacts
IA	Switch On/Off	TB	Low Temperature Thermostat
IC	Switch N.C. - 1/2 Load	TC	Spider wheel earth
ID	Switch display	TFL	Flange earth
IE	Water Saving Device	TG	Main earth
IF	Switch - Spin Reduction	TH	Thermostat
IP	Door switch	TH1	1st temperature thermostat
IR	Line switch	TH2	2nd temperature thermostat
IS	Water-stop	TH3	3rd temperature thermostat

L	Line or Lamp	THF	Operating thermostat
LB	Low Level	THR	Adjustable thermostat
LN	Normal Level	TM	Motor earth
LS	Pilot lamp	TMB	Main cabinet earth
M	Earth-symbol	TMP	Motor thermal protector
MC	Spin cycle motor	TMS	Thermostop
MI	MOTOR WITH PULLEY	TP	Thermal protector
ML	Wash cycle motor	TPS	Drain pump earth
MO	Terminal Board	TR	Heating element earth
MP	Door dip-switch	TS	Safety thermostat
MR	Thermal Lock	TT	Timer earthing connection
MT	Timer motor	TTH	Earthing Thermostat
MV	Motor fan	TV	Tank earth
MV -Ras	Dryer heating element	ZBN	Timer

## Elektromos ábrák és

### csatlakozások

Cod. 160013878-0

160013878.02

TABELLA FILI BASE

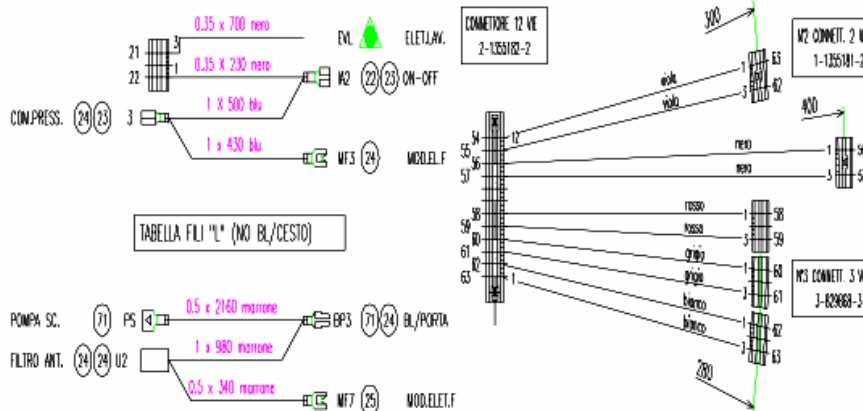
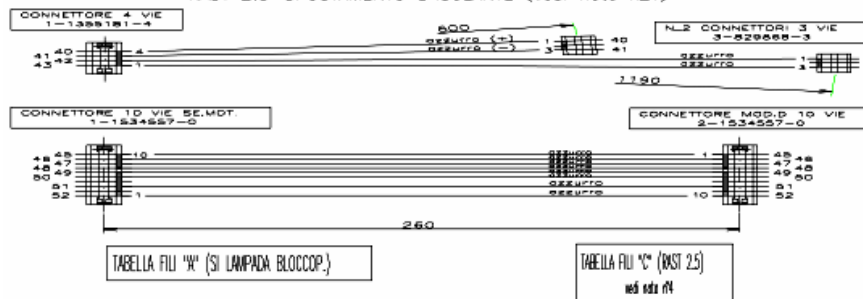
Data inizio validità

16/09/02

ATTENZIONE: IL CABLAGGIO DEVE ESSERE PRODOTTO UTILIZZANDO CAVETTI PRIVI DI STAMPIGLIATURA.

ON/OFF	02	IA1	1 x 310 blu	U4	02	FILTRO ANT.
MODULO ELG	03	MG1	0.75 x 1210 nero	M1	03	MOTORE 1
MODULO ELG	04	MG2	0.75 x 1210 marrone	M2	04	MOTORE 2
MODULO ELG	05	MG3	0.75 x 1210 bianca	M3	05	MOTORE 3
MODULO ELG	06	MG4	0.75 x 1210 blu	M5	06	MOTORE 5
MODULO ELG	07	MG5	0.75 x 1210 rosso	M7	07	MOTORE 7
MODULO ELG	08	MG6	0.75 x 1210 rosso	M8	08	MOTORE 8
MODULO ELE	10	ME2	0.5 x 630 grigio	EVL	10	ELET.LAV.
MODULO ELE	11	ME1	0.5 x 550 bianca	EVP	11	ELET.PREL.
ELET.LAV.	12	ME1	0.5 x 550 bianca	EVP	12	ELET.PREL.
MODULO ELE	13	ME6	0.5 x 550 nero	EVP	13	ELET.PREL.
CONN.1	16	CN3	0.75 x 450 rosso	1	16	VUOTO PR.
CONN.1	17	CN1	1 x 940 bianca	R1	17	RES.RISC.
CONN.1	18	CN2	1 x 450 marrone	2	18	PIENO PR.
MODULO EL.F	19	MF1	0.5 x 430 azzurro	4	19	ANTITRAZ.
POMPA SC.	20	PS	0.5 x 1660 azzurro	4	20	ANTITRAZ.
MODULO EL.F	26	MF8	0.5 x 1130 rosso	BP2	26	BLOCCOP.
RES.RISC.	27	RTA	1 x 1660 rosso	BP2	27	BLOCCOP.
MODULO EL.F	28	MF4	0.5 x 1130 grigio	BP1	28	BLOCCOP.
TERRA GEN.	70		1 x 1000 giallo v.		70	MOTORE
RESISTENZA	71		1 x 300 giallo v.		71	MOTORE

RAST 2,5-SPOSTAMENTO D'ISOLANTE (vedi nota n.4)



## leírás

leírás: 160013878-0

AQS	Aquastop electrovalve	Mzbn/MTA	zbn timer motor
B	Buzzer	N	Neutral or Terminal Board
BC	Blocco Cesto	NC	Spin cycle exclusion
BF	Terminal board contact, motor fan and dryer	P	Pressure switch
BP	Buzzer	P1	1st level pressure cut-off switch
C	Condensator	P2	2nd level pressure cut-off switch
CA	Condensator	PA	High speed potentiometer
DV	Switching device	PB	Low speed potentiometer
EF/CL	Electro-Valve Cold Water / Bleach	PL	Pure Wool
EF/L	Electro-Valve Cold Water / Wash	PM	Motor Thermoprotector
EF/P	Electro-Valve Cold Water / Prewash	PR	Timer programmer or Pressure switch
ER	Exclude Heating Element	PS	Drain pump
ET	Thermostat disactivation	R	Heating element
EV	Electrovalve	RE	Relay
EVA	Dryer electrovalve	RR	Heating element
EVC	Hot water electrovalve	RV	Speed regulator
EVF	Elettrovalvola acqua fredda	Ras/RA	Dryer heating element
EVL	Wash electrovalve	S	LED
EVP	Pre Wash electrovalve	SL	Line LED
FA	Antijamming filter	SO	Door LED
FD	Delicate drying cycle thermostat	SR	Heating LED
FE	Strong drying cycle thermostat	ST	Temperature selector
FRT	Thermofusible Heating Element	SV	Speed Selector for Spin
I	Inverter	T	Timer contacts
II...2...3..	Switches/switching devices	TA	Drying timer contacts
IA	Switch On/Off	TB	Low Temperature Thermostat
IC	Switch N.C. - 1/2 Load	TC	Spider wheel earth
ID	Switch display	TFL	Flange earth
IE	Water Saving Device	TG	Main earth
IF	Switch - Spin Reduction	TH	Thermostat
IP	Door switch	TH1	1st temperature thermostat
IR	Line switch	TH2	2nd temperature thermostat
IS	Water-stop	TH3	3rd temperature thermostat

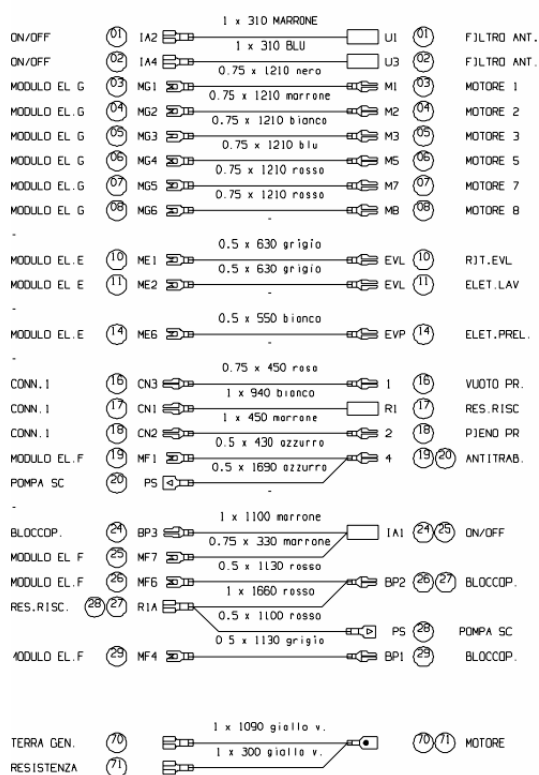
L	Line or Lamp	THF	Operating thermostat
LB	Low Level	THR	Adjustable thermostat
LN	Normal Level	TM	Motor earth
LS	Pilot lamp	TMB	Main cabinet earth
M	Earth-symbol	TMP	Motor thermal protector
MC	Spin cycle motor	TMS	Thermostop
MI	MOTOR WITH PULLEY	TP	Thermal protector
ML	Wash cycle motor	TPS	Drain pump earth
MO	Terminal Board	TR	Heating element earth
MP	Door dip-switch	TS	Safety thermostat
MR	Thermal Lock	TT	Timer earthing connection
MT	Timer motor	TTH	Earthing Thermostat
MV	Motor fan	TV	Tank earth
MV -Ras	Dryer heating element	ZBN	Timer

## csatlakozások

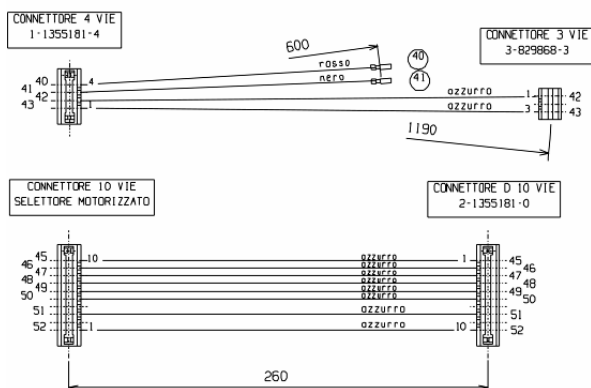
Cod. ce032600

## Elektromos ábrák és

CE032600



RAST 2.5-SPOSTAMENTO D'ISOLANTE (vedi nota n.4)



## leírás

leírás: ce032600

AE	Ignition transformer	PE	Plate electric (Normal and Rapid)
AT	Ignition transformer	PEL	Wall socket
CF	Oven commutator	PIF	Cooking programmer
CP	Plate commutator(Normal end Rapid)	POT	Thermostated potentiometer
CT	Plate commutator(Automatic)	PT	Termoprotector
DC DR	Double Knob double crown burner control card	PTC	Thermostated sensor
EV	Electro-Valve	RCE	Grill heating element ex- ternal
FC	End of cooking programmer	RCI	Grill heating element internal
FRONT	Daschboard	RE	Energy regulator
I/LF	OVEN LIGHT SWITCH	RF	Oven lower heating element
I/LF-MG	OVEN LIGHT SWITCH + ROTISSERIE	RG	Grill heating element
I/MG	TURNSPIT SWITCH	RG COM	Grill heating element un- ion
IL	Knobs' Lighting	RV	Heating element ventilated oven
ILG	Lamp switch turnspit	SA	Boiler operating led
IT	Thermostated switch	SB	Thermostated burner led
L	Line (Feed)	SF	Warning light working
LF	Oven light	SO	Probe temperature
LI	Oven light	SP	Operating Indicator Light for the Plate
M	Suction motor handle	ST	Warning light thermostat
MG	Turnspit motor	TH	Thermostat fixed
MO	Terminal board	TH2	Thermostated burner cooling
MUFF	Oven	THR	Adjustable thermostat
MV	Fan motor	TP	Termoprotector
N	Neutral (Feed)	TRAV	Support terminal board
PA	Ignition push-button	TRM	Thermostated burner control card

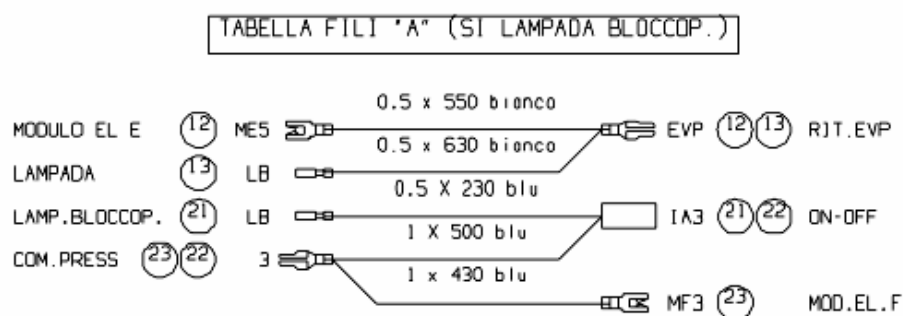
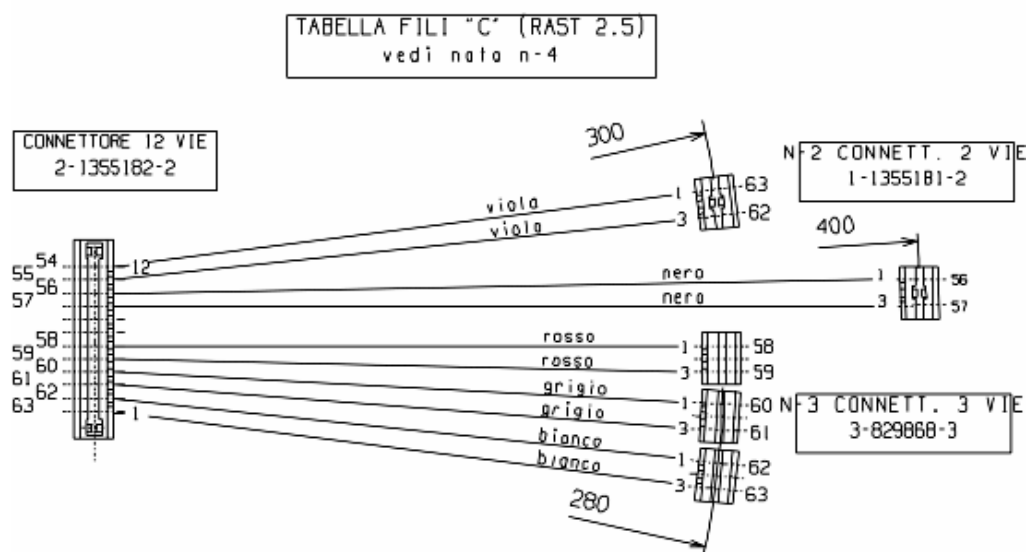


## Elektromos ábrák és

### csatlakozások

Cod. ce032610

CE032610



## leírás

leírás: ce032610

AQS	Aquastop electrovalve	Mzbn/MTA	zbn timer motor
B	Buzzer	N	Neutral or Terminal Board
BC	Blocco Cesto	NC	Spin cycle exclusion
BF	Terminal board contact, motor fan and dryer	P	Pressure switch
BP	Buzzer	P1	1st level pressure cut-off switch
C	Condensator	P2	2nd level pressure cut-off switch
CA	Condensator	PA	High speed potentiometer
DV	Switching device	PB	Low speed potentiometer
EF/CL	Electro-Valve Cold Water / Bleach	PL	Pure Wool
EF/L	Electro-Valve Cold Water / Wash	PM	Motor Thermoprotector
EF/P	Electro-Valve Cold Water / Prewash	PR	Timer programmer or Pressure switch
ER	Exclude Heating Element	PS	Drain pump
ET	Thermostat disactivation	R	Heating element
EV	Electrovalve	RE	Relay
EVA	Dryer electrovalve	RR	Heating element
EVC	Hot water electrovalve	RV	Speed regulator
EVF	Elettrovalvola acqua fredda	Ras/RA	Dryer heating element
EVL	Wash electrovalve	S	LED
EVP	Pre Wash electrovalve	SL	Line LED
FA	Antijamming filter	SO	Door LED
FD	Delicate drying cycle thermostat	SR	Heating LED
FE	Strong drying cycle thermostat	ST	Temperature selector
FRT	Thermofusible Heating Element	SV	Speed Selector for Spin
I	Inverter	T	Timer contacts
II...2...3..	Switches/switching devices	TA	Drying timer contacts
IA	Switch On/Off	TB	Low Temperature Thermostat
IC	Switch N.C. - 1/2 Load	TC	Spider wheel earth
ID	Switch display	TFL	Flange earth
IE	Water Saving Device	TG	Main earth
IF	Switch - Spin Reduction	TH	Thermostat
IP	Door switch	TH1	1st temperature thermostat
IR	Line switch	TH2	2nd temperature thermostat
IS	Water-stop	TH3	3rd temperature thermostat

L	Line or Lamp	THF	Operating thermostat
LB	Low Level	THR	Adjustable thermostat
LN	Normal Level	TM	Motor earth
LS	Pilot lamp	TMB	Main cabinet earth
M	Earth-symbol	TMP	Motor thermal protector
MC	Spin cycle motor	TMS	Thermostop
MI	MOTOR WITH PULLEY	TP	Thermal protector
ML	Wash cycle motor	TPS	Drain pump earth
MO	Terminal Board	TR	Heating element earth
MP	Door dip-switch	TS	Safety thermostat
MR	Thermal Lock	TT	Timer earthing connection
MT	Timer motor	TTH	Earthing Thermostat
MV	Motor fan	TV	Tank earth
MV -Ras	Dryer heating element	ZBN	Timer

csatlakozások

Cod. Ig039700

Elektromos ábrák és



## leírás

leírás: Ig039700

AQS	Aquastop electrovalve	Mzbn/MTA	zbn timer motor
B	Buzzer	N	Neutral or Terminal Board
BC	Blocco Cesto	NC	Spin cycle exclusion
BF	Terminal board contact, motor fan and dryer	P	Pressure switch
BP	Buzzer	P1	1st level pressure cut-off switch
C	Condensator	P2	2nd level pressure cut-off switch
CA	Condensator	PA	High speed potentiometer
DV	Switching device	PB	Low speed potentiometer
EF/CL	Electro-Valve Cold Water / Bleach	PL	Pure Wool
EF/L	Electro-Valve Cold Water / Wash	PM	Motor Thermoprotector
EF/P	Electro-Valve Cold Water / Prewash	PR	Timer programmer or Pressure switch
ER	Exclude Heating Element	PS	Drain pump
ET	Thermostat disactivation	R	Heating element
EV	Electrovalve	RE	Relay
EVA	Dryer electrovalve	RR	Heating element
EVC	Hot water electrovalve	RV	Speed regulator
EVF	Elettrovalvola acqua fredda	Ras/RA	Dryer heating element
EVL	Wash electrovalve	S	LED
EVP	Pre Wash electrovalve	SL	Line LED
FA	Antijamming filter	SO	Door LED
FD	Delicate drying cycle thermostat	SR	Heating LED
FE	Strong drying cycle thermostat	ST	Temperature selector
FRT	Thermofusible Heating Element	SV	Speed Selector for Spin
I	Inverter	T	Timer contacts
II...2...3..	Switches/switching devices	TA	Drying timer contacts
IA	Switch On/Off	TB	Low Temperature Thermostat
IC	Switch N.C. - 1/2 Load	TC	Spider wheel earth
ID	Switch display	TFL	Flange earth
IE	Water Saving Device	TG	Main earth
IF	Switch - Spin Reduction	TH	Thermostat
IP	Door switch	TH1	1st temperature thermostat
IR	Line switch	TH2	2nd temperature thermostat
IS	Water-stop	TH3	3rd temperature thermostat

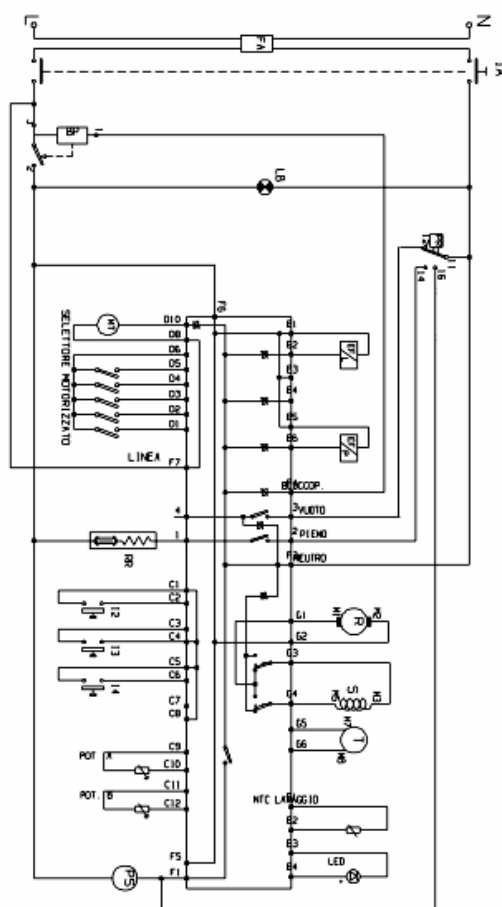
L	Line or Lamp	THF	Operating thermostat
LB	Low Level	THR	Adjustable thermostat
LN	Normal Level	TM	Motor earth
LS	Pilot lamp	TMB	Main cabinet earth
M	Earth-symbol	TMP	Motor thermal protector
MC	Spin cycle motor	TMS	Thermostop
MI	MOTOR WITH PULLEY	TP	Thermal protector
ML	Wash cycle motor	TPS	Drain pump earth
MO	Terminal Board	TR	Heating element earth
MP	Door dip-switch	TS	Safety thermostat
MR	Thermal Lock	TT	Timer earthing connection
MT	Timer motor	TTH	Earthing Thermostat
MV	Motor fan	TV	Tank earth
MV -Ras	Dryer heating element	ZBN	Timer

## Elektromos ábrák és

### csatlakozások

Cod. se089100

SE089100



#### LEGENDA

SEL. A - selettore A	selector A	selecteur A	Selektor A	Selector A	Selector A
SEL. B - selettore B	selector B	selecteur B	Selektor B	Selector B	Selector B
I2 - Interruttore 2	switch 2	Interrupteur 2	chalter 2	Interrupitor 2	Interrupitor 2
I3 - Interruttore 3	switch 3	Interrupteur 3	chalter 3	Interrupitor 3	Interrupitor 3
I4 - Interruttore 4	switch 4	Interrupteur 4	chalter 4	Interrupitor 4	Interrupitor 4
L0 - lampada bloccaporta	Door locked light	lampe Porte Verrouillee	Leuchte Tür verriegelt	Lámpara Puerta bloqueada	Lámpara Puerta trancada

## leírás

leírás: se089100

AQS	Aquastop electrovalve	Mzbn/MTA	zbn timer motor
B	Buzzer	N	Neutral or Terminal Board
BC	Blocco Cesto	NC	Spin cycle exclusion
BF	Terminal board contact, motor fan and dryer	P	Pressure switch
BP	Buzzer	P1	1st level pressure cut-off switch
C	Condensator	P2	2nd level pressure cut-off switch
CA	Condensator	PA	High speed potentiometer
DV	Switching device	PB	Low speed potentiometer
EF/CL	Electro-Valve Cold Water / Bleach	PL	Pure Wool
EF/L	Electro-Valve Cold Water / Wash	PM	Motor Thermoprotector
EF/P	Electro-Valve Cold Water / Prewash	PR	Timer programmer or Pressure switch
ER	Exclude Heating Element	PS	Drain pump
ET	Thermostat disactivation	R	Heating element
EV	Electrovalve	RE	Relay
EVA	Dryer electrovalve	RR	Heating element
EVC	Hot water electrovalve	RV	Speed regulator
EVF	Elettrovalvola acqua fredda	Ras/RA	Dryer heating element
EVL	Wash electrovalve	S	LED
EVP	Pre Wash electrovalve	SL	Line LED
FA	Antijamming filter	SO	Door LED
FD	Delicate drying cycle thermostat	SR	Heating LED
FE	Strong drying cycle thermostat	ST	Temperature selector
FRT	Thermofusible Heating Element	SV	Speed Selector for Spin
I	Inverter	T	Timer contacts
II...2...3..	Switches/switching devices	TA	Drying timer contacts
IA	Switch On/Off	TB	Low Temperature Thermostat
IC	Switch N.C. - 1/2 Load	TC	Spider wheel earth
ID	Switch display	TFL	Flange earth
IE	Water Saving Device	TG	Main earth
IF	Switch - Spin Reduction	TH	Thermostat
IP	Door switch	TH1	1st temperature thermostat
IR	Line switch	TH2	2nd temperature thermostat
IS	Water-stop	TH3	3rd temperature thermostat



L	Line or Lamp	THF	Operating thermostat
LB	Low Level	THR	Adjustable thermostat
LN	Normal Level	TM	Motor earth
LS	Pilot lamp	TMB	Main cabinet earth
M	Earth-symbol	TMP	Motor thermal protector
MC	Spin cycle motor	TMS	Thermostop
MI	MOTOR WITH PULLEY	TP	Thermal protector
ML	Wash cycle motor	TPS	Drain pump earth
MO	Terminal Board	TR	Heating element earth
MP	Door dip-switch	TS	Safety thermostat
MR	Thermal Lock	TT	Timer earthing connection
MT	Timer motor	TTH	Earthing Thermostat
MV	Motor fan	TV	Tank earth
MV -Ras	Dryer heating element	ZBN	Timer