



Service Manual

Freestanding Double Door ARC 4190/IX

Model	ARC 4190/IX	
Version	8501 419 01040	Page
	Technical data	2
	Spare part list	3 - 4
	Exploded view	5 - 6
	Circuit and Wiring diagram	7
	Text/Legend	8

Technical data

Dimensions

Height	187.4	cm
Width	70.9	cm
Depth	72.8	cm

Capacity

Total		
gross	440	l
net	436	l
Cooling		
gross	330	l
net	328	l
Freezing		
gross	110	l
net	108	l

Electrical connection

Voltage	220 - 240	V
Frequency	50	Hz

Power consumption

in 24 hours	1.15	kWh
-------------	------	-----

Freezing capacity

in 24 hours	5	kg
-------------	---	----

Compressor (freezing)

Type	EGM 90 CLC	
Capacity (CECOMAF)	166	W

Refrigerant (freezing)

Type	R 600 a	
Quantity	56	g

Thermostat (Cooling)

Electronic

Thermostat (Freezing)

Electronic

Thermostat switching value (cooling)

MIN.		
Switch on temperature	+ 10.0	°C
Switch off temperature	+ 8.0	°C
MED.		
Switch on temperature	+ 8.0	°C
Switch off temperature	+ 6.0	°C

MAX.		
Switch on temperature	+ 4.0	°C
Switch off temperature	+ 2.0	°C

Thermostat switching value (freezing)

MIN.		
Switch on temperature	- 17.0	°C
Switch off temperature	- 23.0	°C
MED.		
Switch on temperature	- 20.0	°C
Switch off temperature	- 26.0	°C

MAX.		
Switch on temperature	- 23.0	°C
Switch off temperature	- 29.0	°C

Spare part list

Model ARC 4190/IX
Service No. 850141901040
Version 850141901040

Pos. No.	12NC Code	Description
003 0	4812 442 29269	Base compressor
011 0	4812 462 18245	Foot adjust.
012 0	4812 528 78071	Roller
012 1	4812 535 48009	Shaft
012 3	4812 528 78072	Roller
040 0	4812 417 19285	Hinge, upper
040 1	4812 462 28629	Cover, hinge
040 2	4812 417 19284	Hinge
040 3	4812 462 28631	Cover black color
040 4	4812 462 28623	Cover, hinge color black
040 5	4812 417 19277	Hinge
040 6	4812 417 19278	Pin hinge, lower
040 7	4812 446 88148	Door revers.Kit left side, silver color
047 0	4812 462 28397	Bushing, upper
047 1	4812 532 88065	Cover bushing gray color
047 2	4812 446 88153	Bushing
050 0	4812 440 89086	Plinth color black
050 1	4812 435 18111	Clamp
050 2	4812 414 58256	Cover color black
086 0	4812 404 48923	Support
086 1	4812 535 38083	Pin
086 2	4812 226 08021	Pin rail
101 0	4812 416 19543	Door, freezer inox
101 1	4812 262 78014	Cover right hand, black
101 2	4812 262 78015	Cover left hand, black color
103 0	4812 262 78016	Cover freezing
103 1	4812 262 78017	Cover
103 2	4812 442 29271	Front crispser
103 3	4812 226 08022	Pin crispser
104 0	4812 416 19535	Door, refrigerator inox
110 0	4812 498 18352	Handle, door, inox
110 1	4812 498 18353	Handle, door, inox
111 7	4812 459 18238	Nameplate
152 0	4812 418 48729	Door, dairy freezing
152 1	4812 418 48731	Door, dairy
152 2	4812 418 28726	Support can
152 3	4812 418 89016	Holder, can
152 4	4812 418 28727	Separator
152 5	4812 418 28728	Separator bottles
152 6	4812 418 28729	Bottle shelf door
156 0	4812 418 28811	Egg trim
191 0	4812 468 18329	Gasket fre. door gray color
191 1	4812 468 18331	Gasket ref. door gray color
239 0	4812 690 28035	Ice maker
239 1	4812 418 28731	Tank
239 2	4812 404 38733	Support ice maker
239 3	4812 418 28733	Tray icecube
241 0	4812 418 28734	Shelf
241 1	4812 418 48799	Shelf
241 3	4812 418 28736	Drawer
242 0	4812 418 28737	Drawer
242 1	4812 442 29272	Front crispser
242 2	4812 418 28738	Spacer
255 0	4812 450 88266	Glass shelf
255 1	4812 418 28739	Shelf extra

Pos. No.	12NC Code	Description
255 2	4812 418 28741	Shelf rear
255 3	4812 418 28742	Shelf front
256 0	4812 123 38002	Diaphragm
256 1	4812 460 48883	Support
256 2	4812 460 48886	Cover
256 3	4812 411 68012	Slide
256 4	4812 411 68013	Slide
261 0	4812 462 38207	Rail freezing, right side
261 1	4812 462 38208	Rail Freezing, left side
261 2	4812 462 38209	Rail right, vegetables drawing
261 3	4812 462 38206	Rail left, vegetables drawing
261 4	4812 462 38211	Rail + stopper, right side
261 5	4812 462 38212	Rail + stopper, left side
261 6	4812 462 38213	Rail
261 7	4812 462 38214	Rail glass shelf, right side
261 8	4812 462 38215	Rail glass shelf, left side
263 0	4812 462 38216	Rail left
263 1	4812 462 38217	Rail right
320 0	4812 214 79278	User board, LCD
320 1	4812 214 79282	Interface set
332 0	4812 227 08016	Button interface, right side
332 1	4812 227 08017	Button interface, left side
402 0	4812 360 38919	Compressor EGM 90 CLC
402 1	4812 418 18319	Tray, compressor
420 0	4812 121 08241	Capacitor
440 0	4812 028 58347	Motor fan
441 0	4812 028 58346	Motor fan freezer
451 0	4812 511 58017	Element defrost
480 0	4812 019 78835	Cable harness compressor
490 0	4812 019 78836	Cable, mains
526 0	4812 282 38158	Control unit
564 0	4812 252 28045	Thermal fuse
614 0	4812 218 38238	Relay + overload prot.
643 0	4812 215 38011	Thermometer WP-SPACE-4/RE/RF/CB
651 0	4812 134 88061	Lamp 220V-15W
652 0	4812 255 18277	Holder, lamp
652 1	4812 462 28624	Protector lamp
652 2	4812 404 68043	Support lamp
691 0	4812 134 28075	Sensor temperature
702 0	4812 526 48181	Tube service
740 1	4812 462 28625	Spacer cabinet
743 0	4812 440 79167	Air diffuser, set
743 1	4812 404 38734	Fastener air diffuser
743 2	4812 440 79138	Coupling air diffuser
743 3	4812 442 29273	Air diffuser door, refrigerator
743 4	4812 442 29294	Air guide
743 5	4812 462 28626	Cover air diffuser
745 0	4812 511 38272	Evaporator set
745 1	4812 440 29471	Heat shield
745 2	4812 440 29472	Spacebar right
745 3	4812 440 29473	Spacebar left
745 4	4812 404 38735	Support sensor
746 1	4812 462 28627	Cover, front evaporator
746 2	4812 462 28628	Cover, rear evaporator
746 3	4812 404 18457	Support sensor

Spare part list

Model	ARC 4190/IX
Service No.	850141901040
Version	850141901040

Pos. No.	12NC Code	Description
764 0	4819 526 48527	Dryer
904 0	4812 404 48919	Clamp right hand
904 1	4812 404 38736	Clamp left hand
904 2	4812 526 48192	Bushing
904 3	4812 226 08023	Pin

Exploded view

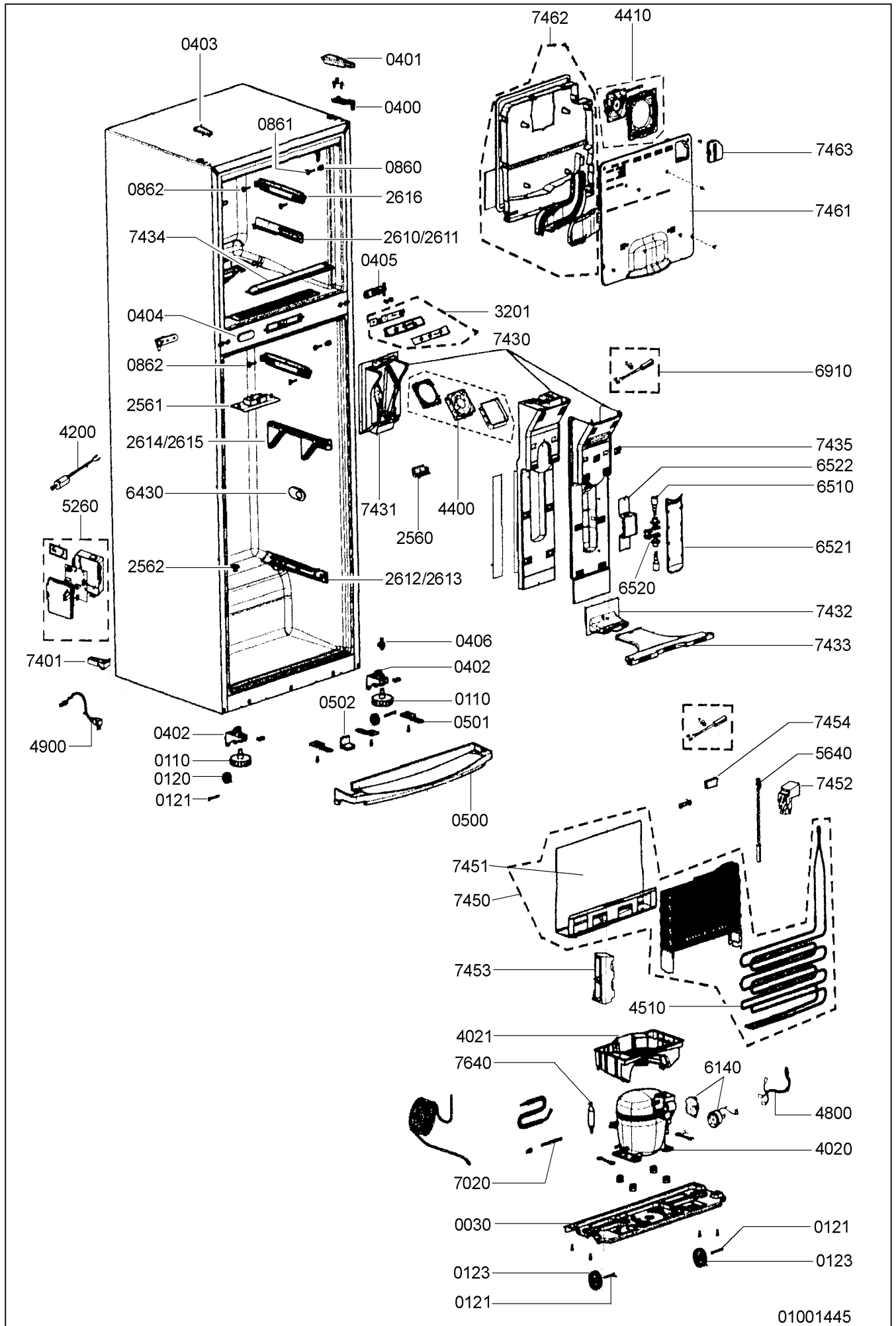

Exploded view

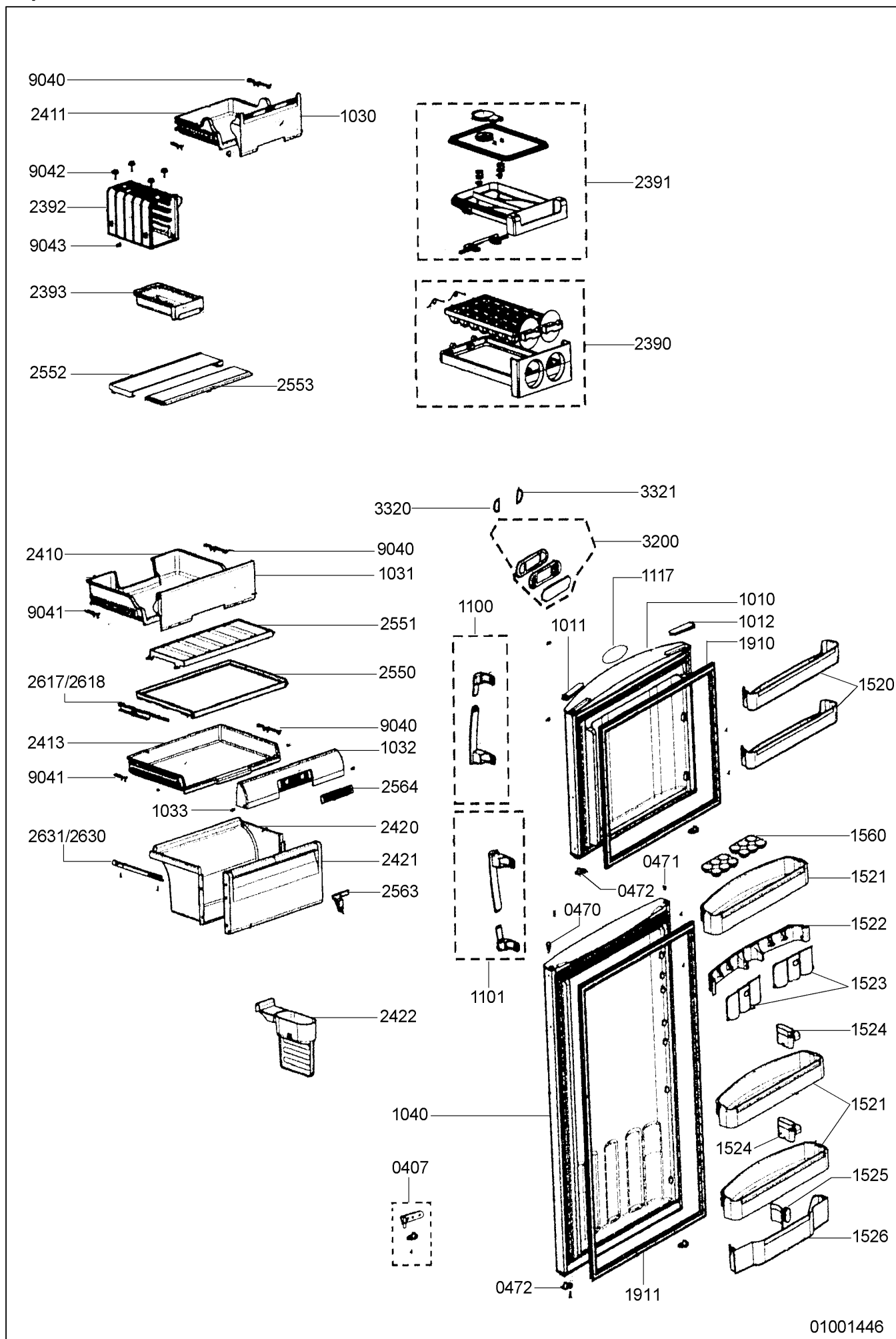

Circuit and Wiring diagram

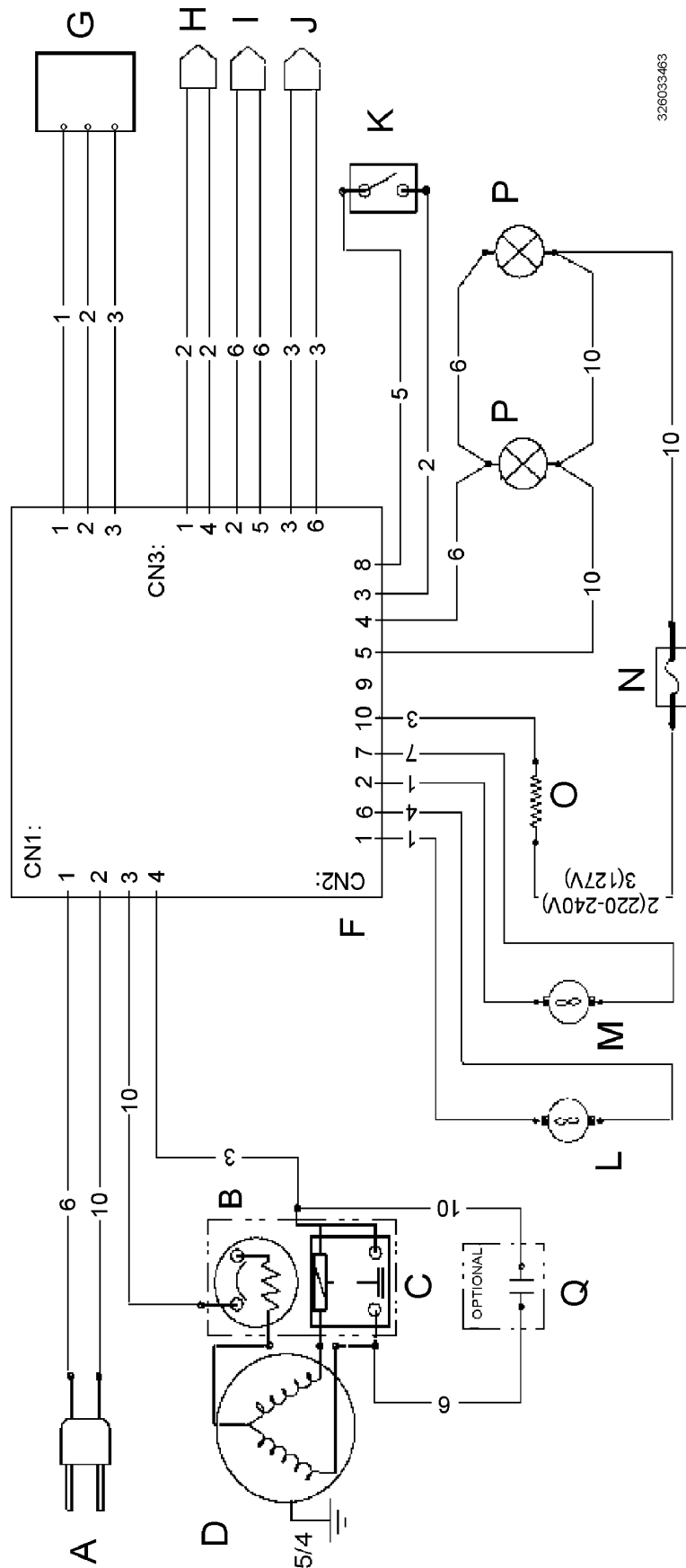

NOMINAL RATED	MINIMUM	MAXIMUM
127V	104V	140V
220V	198V	242V
220V/230V	198V	253V
220V/240V	198V	264V
230V(INDIA)	198V	260V

OPTIONAL	A
OPTIONAL	E

L REF. FAN MOTOR
M FREEZER FAN MOTOR
N THERMOFUSE
O DEFROST HEATER
P REFRIGERATOR LAMP
Q RUNNING CAPACITOR

A POWER CORD
B OVERLOAD PROTECTOR
C RELAIS
D COMPRESSOR
E PTC
F ELECTRONIC BOARD
G INTERFACE BOARD
H DEFROST TEMP. SENSOR
I FREEZER TEMP. SENSOR
J REF. TEMP SENSOR
K REED SWITCH BOARD

1 BLACK
2 RED
3 WHITE
4 YELLOW
5 GREEN
6 BROWN
7 ORANGE
8 PINK
9 GREY
10 BLUE
11 VIOLET

4812 711 78132

Text/Legend

Temperature (°C)	NTC Resistance (ohm)	Accuracy	
		(± °C)	(± Ω)
50	967,42	0,5	
40	1429,27	0,5	
30	2160,92	0,5	
20	3350,00	0,5	
10	5335	0,5	137
9,5	5464	0,5	139
9	5598	0,5	142
8,5	5735	0,5	144
8	5876	0,5	147
7,5	6021	0,5	150
7	6170	0,5	153
6,5	6323	0,5	155
6	6480	0,5	159
5,5	6642	0,5	162
5	6808	0,5	165
4,5	6979	0,5	168
4	7155	0,5	172
3,5	7335	0,5	175
3	7521	0,5	179
2,5	7713	0,5	183
2	7909	0,5	187
1,5	8112	0,5	191
1	8320	0,5	196
0,5	8534	0,5	200
0	8755	0,5	205
-0,5	8982	0,5	210
-1	9215	0,5	215
-1,5	9456	0,5	220
-2	9703	0,5	226
-2,5	9958	0,5	231
-3	10221	0,5	237
-3,5	10491	0,4	243
-4	10769	0,4	250
-4,5	11055	0,4	256
-5	11350	0,4	263
-5,5	11654	0,4	271
-6	11967	0,4	278
-6,5	12290	0,4	286
-7	12622	0,4	295
-7,5	12965	0,4	303
-8	13318	0,4	312
-8,5	13681	0,4	322
-9	14056	0,4	332
-9,5	14442	0,4	342
-10	14841	0,4	353
-10,5	15251	0,4	364
-11	15675	0,4	376
-11,5	16111	0,4	388
-12	16561	0,4	401

Temperature (°C)	NTC Resistance (ohm)	Accuracy	
		(± °C)	(± Ω)
-12,5	17026	0,4	415
-13	17505	0,4	429
-13,5	17999	0,5	444
-14	18508	0,5	460
-14,5	19034	0,5	476
-15	19577	0,5	493
-15,5	20137	0,5	511
-16	20715	0,5	530
-16,5	21311	0,5	550
-17	21927	0,5	571
-17,5	22562	0,5	592
-18	23218	0,5	615
-18,5	23896	0,5	640
-19	24596	0,5	664
-19,5	25318	0,5	691
-20	26065	0,5	718
-20,5	26835	0,5	748
-21	27632	0,5	778
-21,5	28455	0,5	811
-22	29305	0,5	844
-22,5	30183	0,5	880
-23	31091	0,5	918
-23,5	32030	0,5	957
-24	33000	0,5	998
-24,5	34003	0,5	1042
-25	35040	0,5	1088
-25,5	36112	0,5	1136
-26	37221	0,5	1187
-26,5	38368	0,5	1240
-27	39554	0,5	1296
-27,5	40781	0,6	1355
-28	42050	0,6	1218
-28,5	43364	0,6	1483
-29	44723	0,6	1552
-29,5	46130	0,6	1625
-30	47586	0,6	1702
-30,5	49093	0,6	1783
-31	50653	0,6	1868
-31,5	52268	0,6	1958
-32	53941	0,6	2052
-32,5	55673	0,6	2152
-33	57467	0,6	2257
-33,5	59326	0,6	2368
-34	61251	0,6	2484
-34,5	63245	0,7	2608

326013997